

# COURTHOUSE CENTER

ROCKVILLE, MD

1,538 - 4,872 SF AVAILABLE







**RAPPAPORT**  
CULTIVATING PLACES

## COURTHOUSE CENTER

### ROCKVILLE, MD

- Former restaurant space available, also seeking great service users
- Plentiful surface parking and visibility along North Washington Street & East Middle Lane
- Situated adjacent to Rockville Town Square with an incredible mix of national and regional tenants, including First Watch, Bonchon, Color Me Mine, Starbucks, Dawson's Market, and more
- Located on Washington Street, diagonally across from the Montgomery County Courthouse

### DEMOGRAPHICS 2024

	1 MILE	3 MILES	5 MILES
 <b>POPULATION</b>	19,087	116,761	333,771
 <b>DAYTIME POPULATION</b>	26,997	158,379	312,020
 <b>HOUSEHOLD INCOME</b>	\$133,582	\$158,060	\$156,255
 <b>TRAFFIC COUNTS</b>	53,000 on Rockville Pike		

### AREA RETAILERS



**COURTHOUSE CENTER**  
ROCKVILLE, MD

**MONTGOMERY COLLEGE**  
26,155 Students  
1,376 Faculty

**ROCKVILLE TOWN SQUARE**



CVS pharmacy  
Peter & Chang



Walgreens

pot

CHOICE  
HOTELS

**ROCKVILLE METRO**  
3,943 DAILY RIDERS



**COURTHOUSE CENTER**

MONTGOMERY AVENUE

MARYLAND  
28

**ACCESS TO INTERSTATE 270**  
(4.4 MILES FROM SITE)

**10,000+ TOTAL POPULATION WEST OF SITE**

GREAT FALLS ROAD

MARYLAND AVENUE

WORLD OF BEER



REGAL CINEMAS

BEN & JERRY'S

California  
TORTILLA

POTBELLY

MARLO

**RITCHIE CENTER**

PNC BANK

ihop



CVS pharmacy

**WINTERGREEN PLAZA**



MISSION BBQ



ROCKVILLE PIKE 53,000 VPD

VEIRS MILL ROAD

WOOTTON PARKWAY



# SITE PLAN

COURTHOUSE CENTER | ROCKVILLE, MD

1,538 - 4,872 SF AVAILABLE

Space	Sq. Ft	Tenant Name
1	1,524	Subway
2	2,864	Woodside Deli
4	2,620	Available
5	2,424	Available
9	10,925	East Dumpling House
16	2,500	Veterinary Holistic Care
16B	1,248	Rick's Barber Shop
17	4,872	Available
17B	1,029	Veterinary Holistic Care
18	5,960	Mansfield Kaseman Clinic
18A	1,538	Available

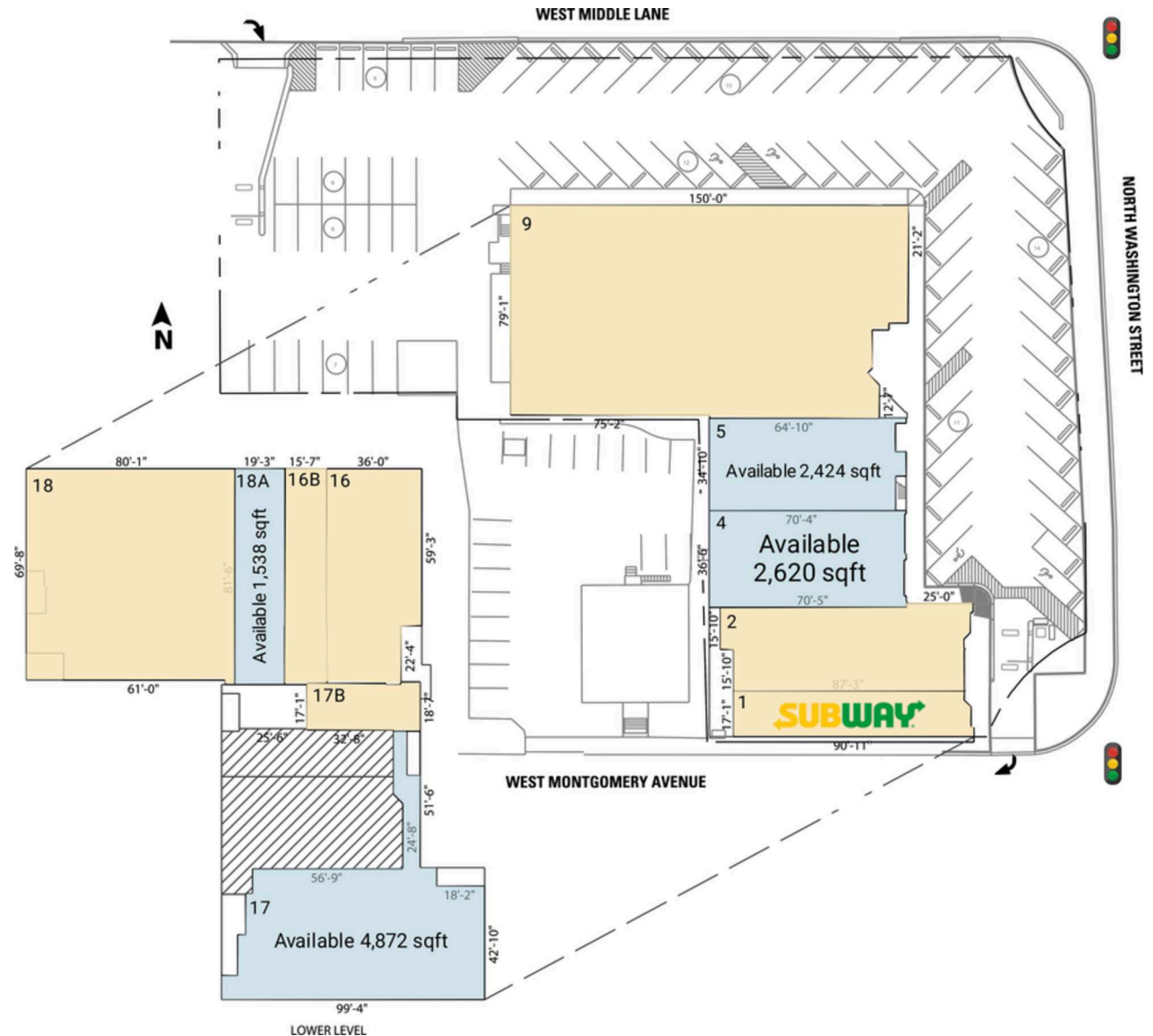

# COURTHOUSE CENTER

ROCKVILLE, MD





**COURTHOUSE CENTER | 12 N WASHINGTON STREET, ROCKVILLE, MD**

**Mike Howard | [mhoward@rappaportco.com](mailto:mhoward@rappaportco.com) | 571.382.1219**

**Thomas Bolen III | [tbolen@rappaportco.com](mailto:tbolen@rappaportco.com) | 571.382.1291**

**[rappaportco.com](http://rappaportco.com)**