

1200 19TH STREET NW

WASHINGTON, DC

971 SF AVAILABLE





RAPPAPORT
CULTIVATING PLACES



1200 19TH STREET NW WASHINGTON, DC

- | Located in the vibrant Golden Triangle neighborhood with a variety of national and local tenants
- | A short walk to multiple hotels including The St. Gregory, The Washington Marriott, The Ritz Carlton and The Renaissance Washington
- | Outdoor seating and blade signage available
- | 971 SF corner available on 19th Street & M Street NW

DEMOGRAPHICS 2024

	0.25 MILE	0.5 MILE	1 MILE
 POPULATION	3,188	17,312	74,489
 DAYTIME POPULATION	56,421	179,530	356,257
 HOUSEHOLD INCOME	\$120,258	\$139,498	\$152,472
 TRAFFIC COUNTS	12,600 on 19th Street NW		

AREA RETAILERS

JOS. A. BANK

CHANG
CHANG

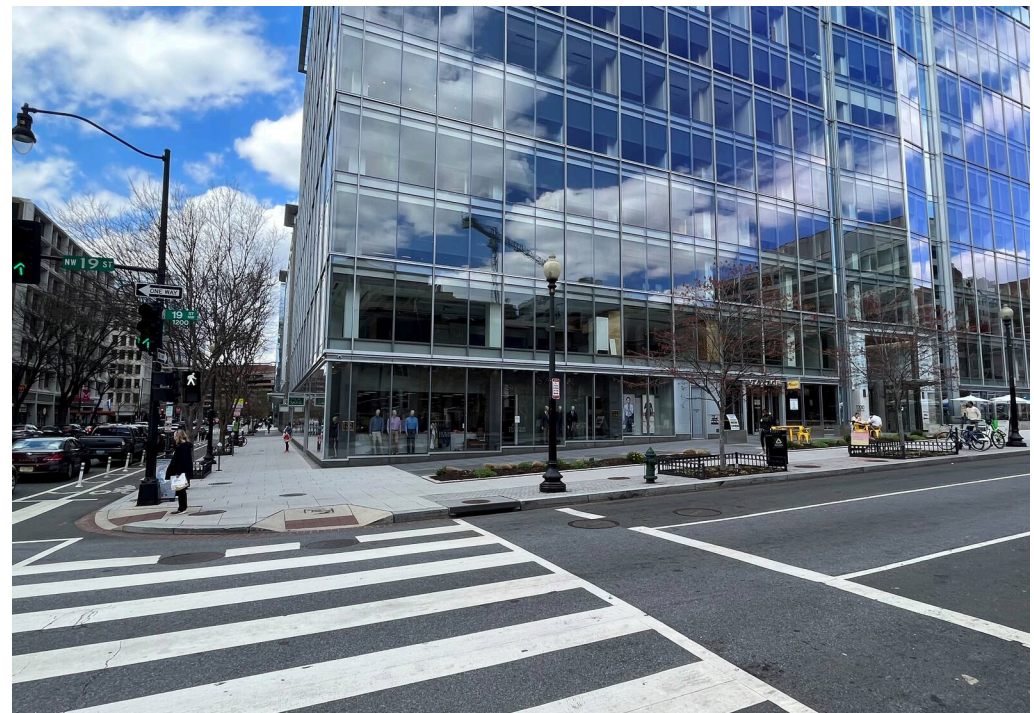
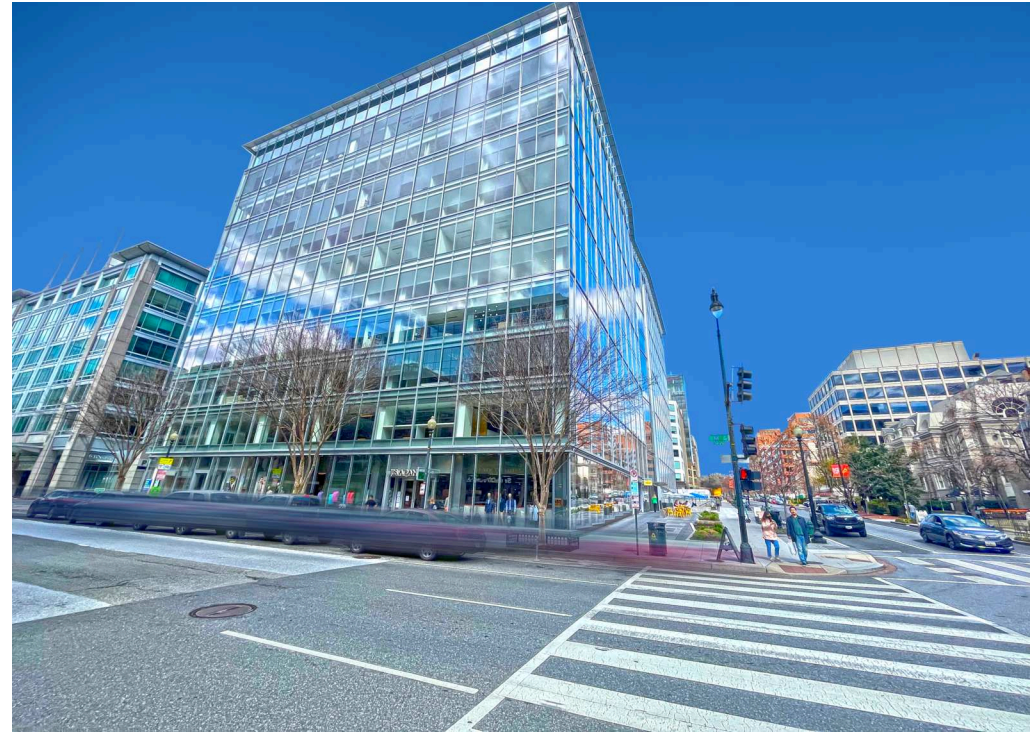

1200 19TH STREET NW
WASHINGTON, DC

DUPONT CIRCLE NW



BARRY'S BOOTCAMP **CHOPT**

Toastique



1200 19TH STREET NW



19TH STREET NW 12,600 VPD

Tatte
 BAKERY & CAFÉ

BOQUERIA CAVA



NEW HAMPSHIRE AVENUE NW

21ST STREET NW



M STREET NW 21,800 VPD



Wawa **M&T Bank**
 CHOPT

CONNECTICUT AVENUE NW 27,200 VPD



NORDSTROM
rack

L STREET NW

SITE PLAN

1200 19TH STREET NW | WASHINGTON, DC
971 SF AVAILABLE

M STREET NW 21,800 VPD

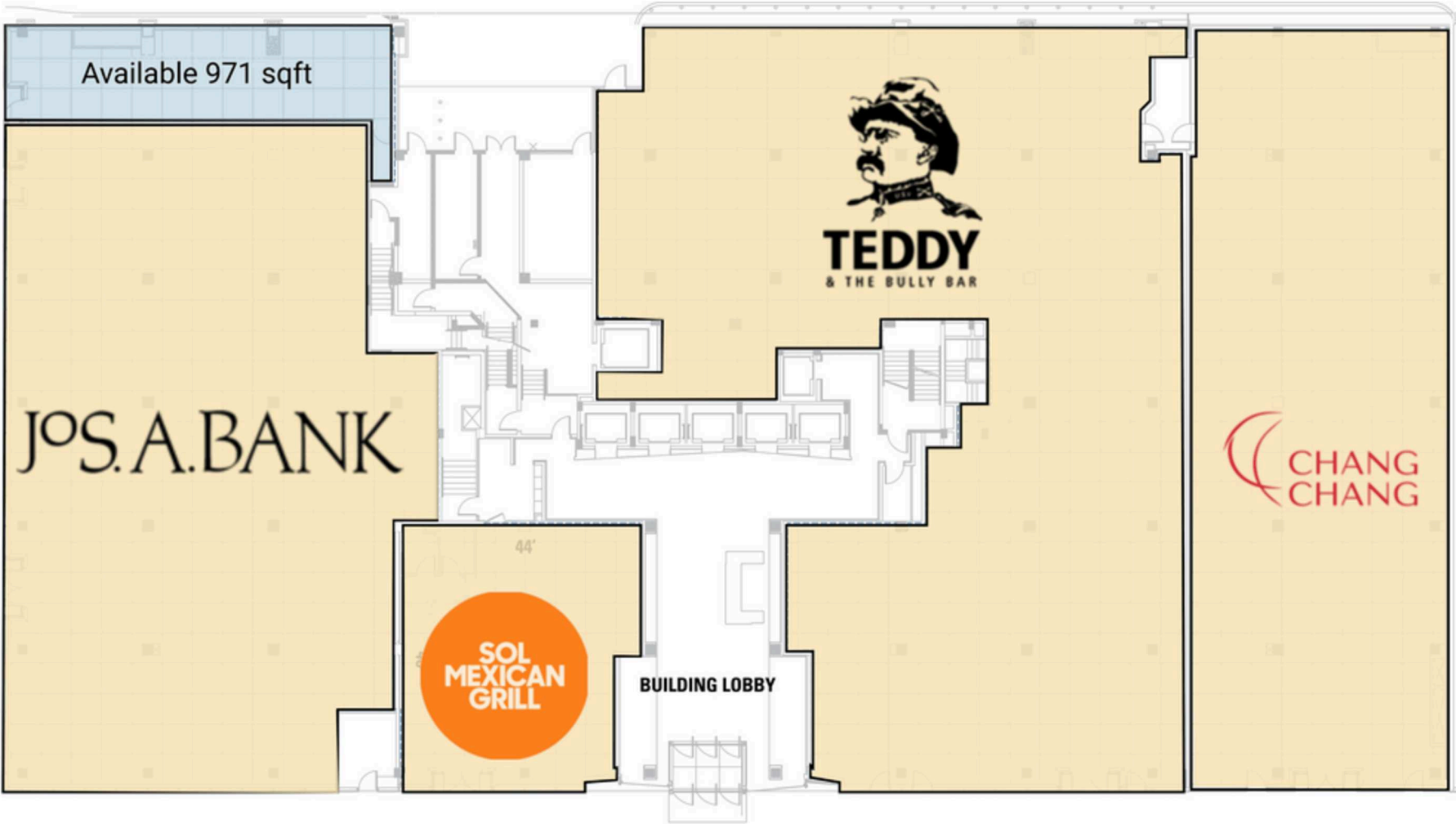

19TH STREET NW 12,600 VPD



1200 19TH STREET NW | 1200 19TH STREET NW, WASHINGTON, DC

Kyle Gamber | kgamber@rappaportco.com | 571.382.1216

Bill Dickinson | bdickinson@rappaportco.com | 703.310.6983

rappaportco.com