

# 1200 19TH STREET NW

WASHINGTON, DC

971 SF AVAILABLE

RAPPAPORT  
CULTIVATING PLACES









## 1200 19TH STREET NW WASHINGTON, DC

- | Located in the vibrant Golden Triangle neighborhood with a variety of national and local tenants
- | A short walk to multiple hotels including The St. Gregory, The Washington Marriott, The Ritz Carlton and The Renaissance Washington
- | Outdoor seating and blade signage available
- | 971 SF corner available on 19th Street & M Street NW

### DEMOGRAPHICS 2025

	0.25 MILE	0.5 MILE	1 MILE
 POPULATION	3,188	17,312	74,489
 DAYTIME POPULATION	56,421	179,530	356,257
 HOUSEHOLD INCOME	\$120,258	\$139,498	\$152,472
 TRAFFIC COUNTS	12,600 on 19th Street NW		

### AREA RETAILERS

JOS. A. BANK

CHANG  
CHANG

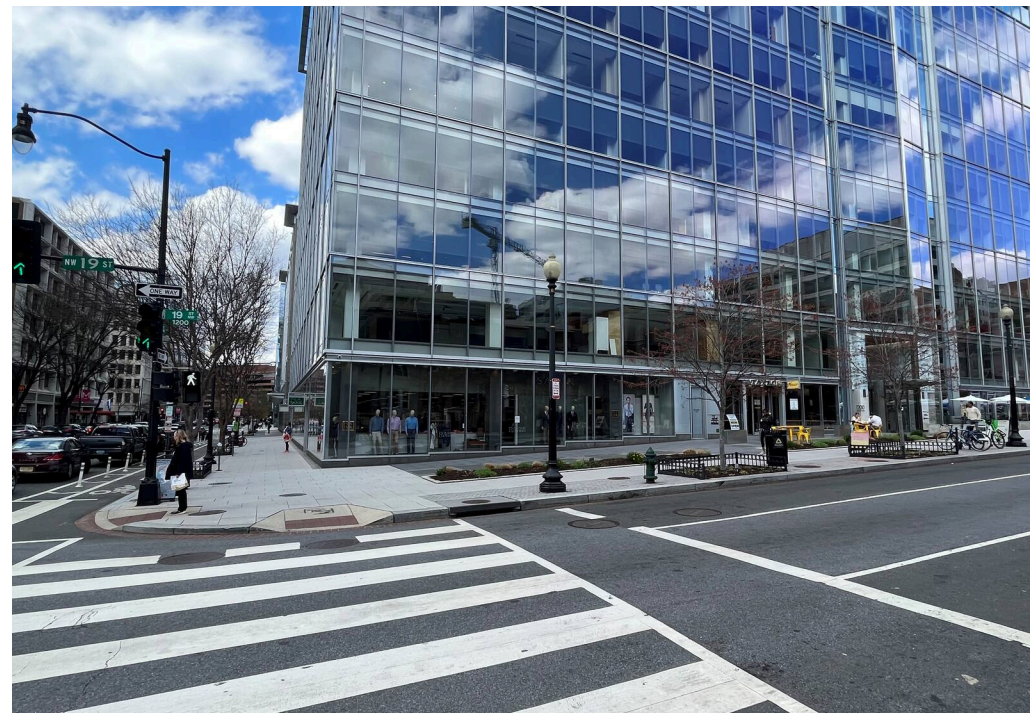
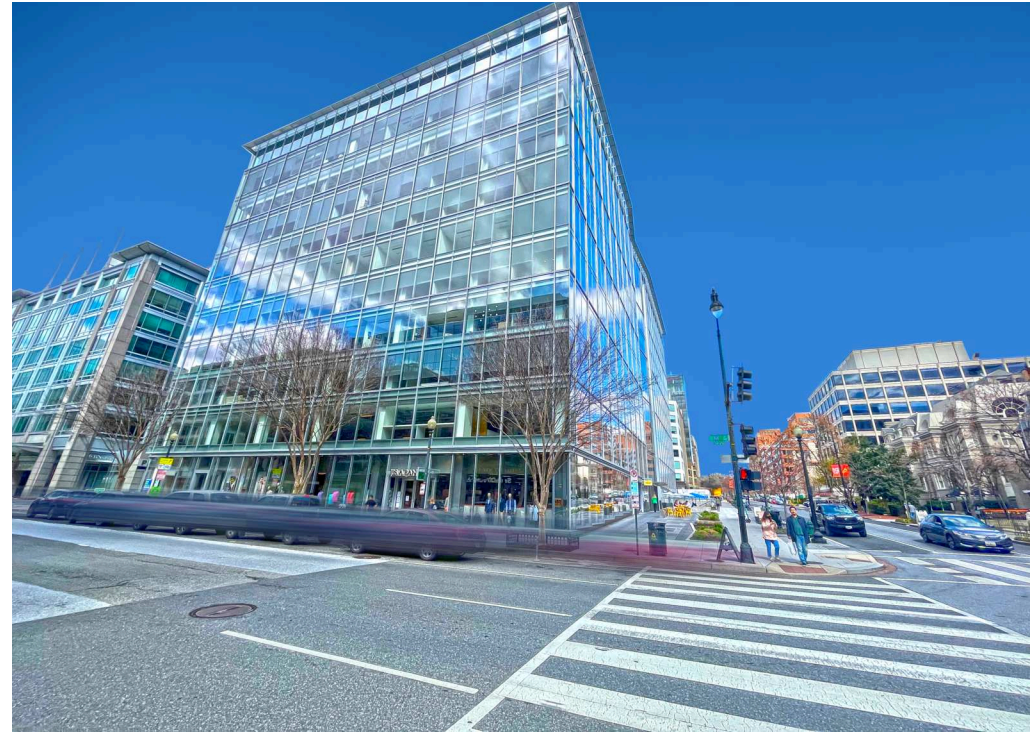



1200 19TH STREET NW  
WASHINGTON, DC

DUPONT CIRCLE NW



**BARRY'S BOOTCAMP**    **CHOPT**  
      
**Toastique**



**1200 19TH STREET NW**

**COLADA SHOP**

19TH STREET NW 12,600 VPD

**BOQUERIA CAVA**   

**Tatte**  
BAKERY & CAFÉ

**THE COFFEE BAR**

**corepower YOGA**

**H&M**

M STREET NW 21,800 VPD

**DISTRICT OF TYGO**

**CVS pharmacy**

**Wawa**    **M&T Bank**  
    **CHOPT**

CONNECTICUT AVENUE NW 27,200 VPD

**NORDSTROM**  
**rack**

**sg**

L STREET NW

21ST STREET NW

20TH STREET NW

NEW HAMPSHIRE AVENUE NW



# SITE PLAN

1200 19TH STREET NW | WASHINGTON, DC

971 SF AVAILABLE

M STREET NW 21,800 VPD

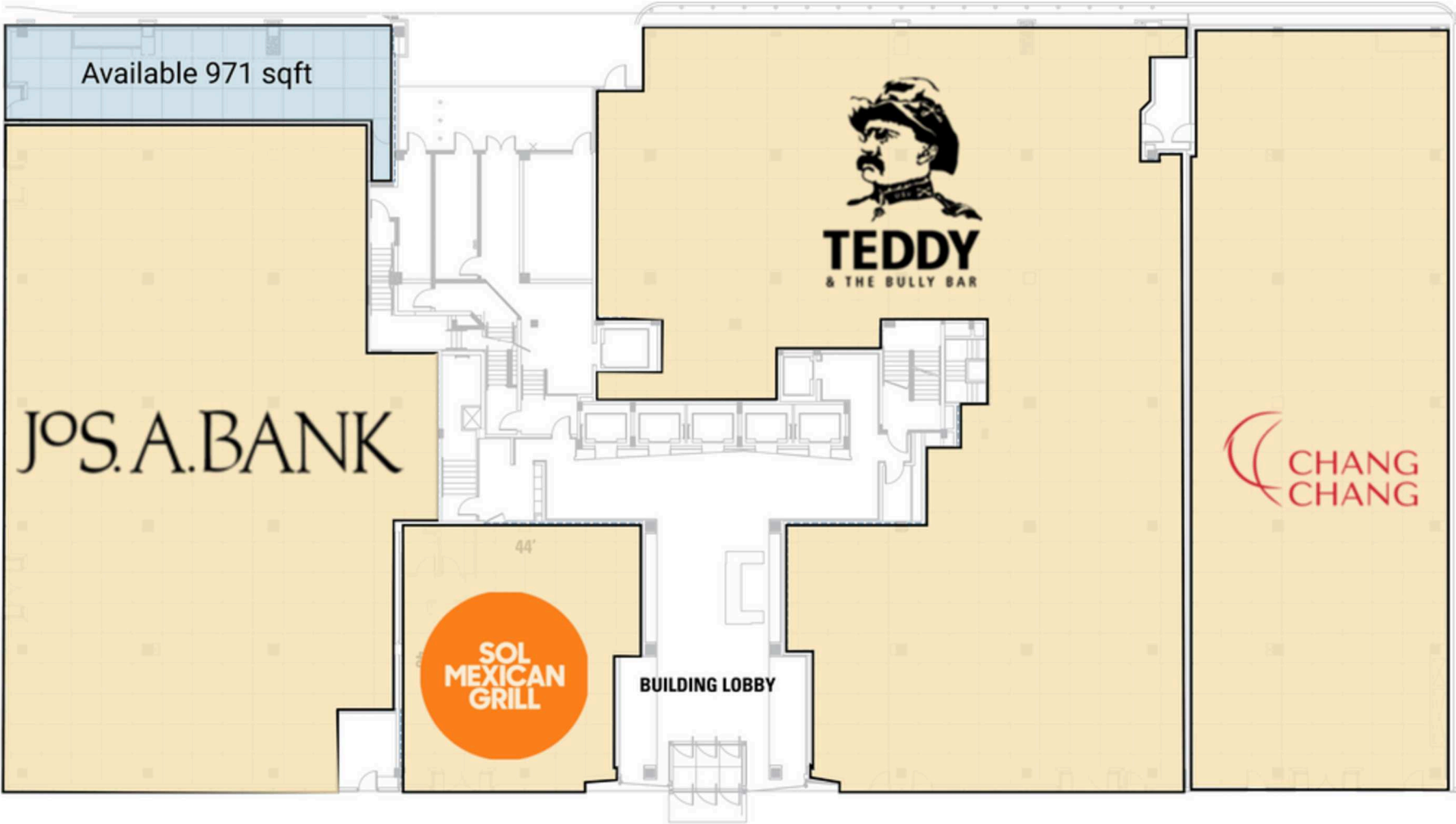

19TH STREET NW 12,600 VPD



**1200 19TH STREET NW | 1200 19TH STREET NW, WASHINGTON, DC**

**Kyle Gamber | [kgamber@rappaportco.com](mailto:kgamber@rappaportco.com) | 571.382.1216**

**Bill Dickinson | [bdickinson@rappaportco.com](mailto:bdickinson@rappaportco.com) | 703.310.6983**

**[rappaportco.com](http://rappaportco.com)**