

# THE LANSBURGH

## WASHINGTON, DC

2,965-6,830 SF 2ND GEN RESTAURANT AND RETAIL SPACES AVAILABLE

RAPPAPORT  
CULTIVATING PLACES









## THE LANSBURGH WASHINGTON, DC

- | Retail and restaurant opportunity in the heart of Penn Quarter
- | Ample customer parking in building garage and central loading dock
- | Co-tenants include The Shakespeare Theater, Jaleo, China Chilcano, and Matchbox
- | One block from the National Mall, two blocks from Capital One Arena, and National Portrait Gallery

### DEMOGRAPHICS 2024

	0.25 MILE	0.5 MILE	1 MILE
 <b>POPULATION</b>	2,094	8,974	38,460
 <b>DAYTIME POPULATION</b>	36,367	108,970	273,517
 <b>HOUSEHOLD INCOME</b>	\$202,132	\$154,316	\$129,871
 <b>TRAFFIC COUNTS</b>	22,475 on 7th Street NW		

### AREA RETAILERS



**6,830 SF ON CORNER  
OF 8TH AND E STREET**



**2,965 SF AVAILABLE  
ON 7TH STREET NW**



## THE LANSBURGH WASHINGTON, DC

CITY CENTER

LV  
LOUIS VUITTON  
corepower  
YOGA

Dior  
FIG & OLIVE  
GUCCI  
BVLGARI

NEW YORK AVENUE

8TH STREET

### DC CONVENTION CENTER

2.3M SF EVENT SPACE  
1,027 CONVENTIONS IN 2016  
~1 MILLION ATTENDEES

CARNEGIE LIBRARY



GALLERY PLACE



REGAL CHOPT

### UNION STATION

31,000 METRO COUNTS



G STREET



700 13TH STREET NW

au bon pain



Bank of America



BANANA REPUBLIC

E STREET 7,527 VPD

7TH STREET NW 22,475 VPD

### CAPITAL ONE ARENA

~2.4 MILLION ANNUALLY  
20,000 SEATS



### CAPITOL CROSSING

2.2M SF  
75K SF RETAIL  
8,000 NEW EMPLOYEES  
(DAYTIME TRAFFIC)

### THE CAPITOL



THE LANSBURGH BUILDING



JALEO



PENNSYLVANIA AVENUE 13,747 VPD

NATIONAL MALL  
33.8M VISITORS ANNUALLY



## 7TH STREET RESTAURANT OPPORTUNITY

THE LANSBURGH | WASHINGTON, DC

2,965 SF 2ND GEN RESTAURANT SPACE AVAILABLE

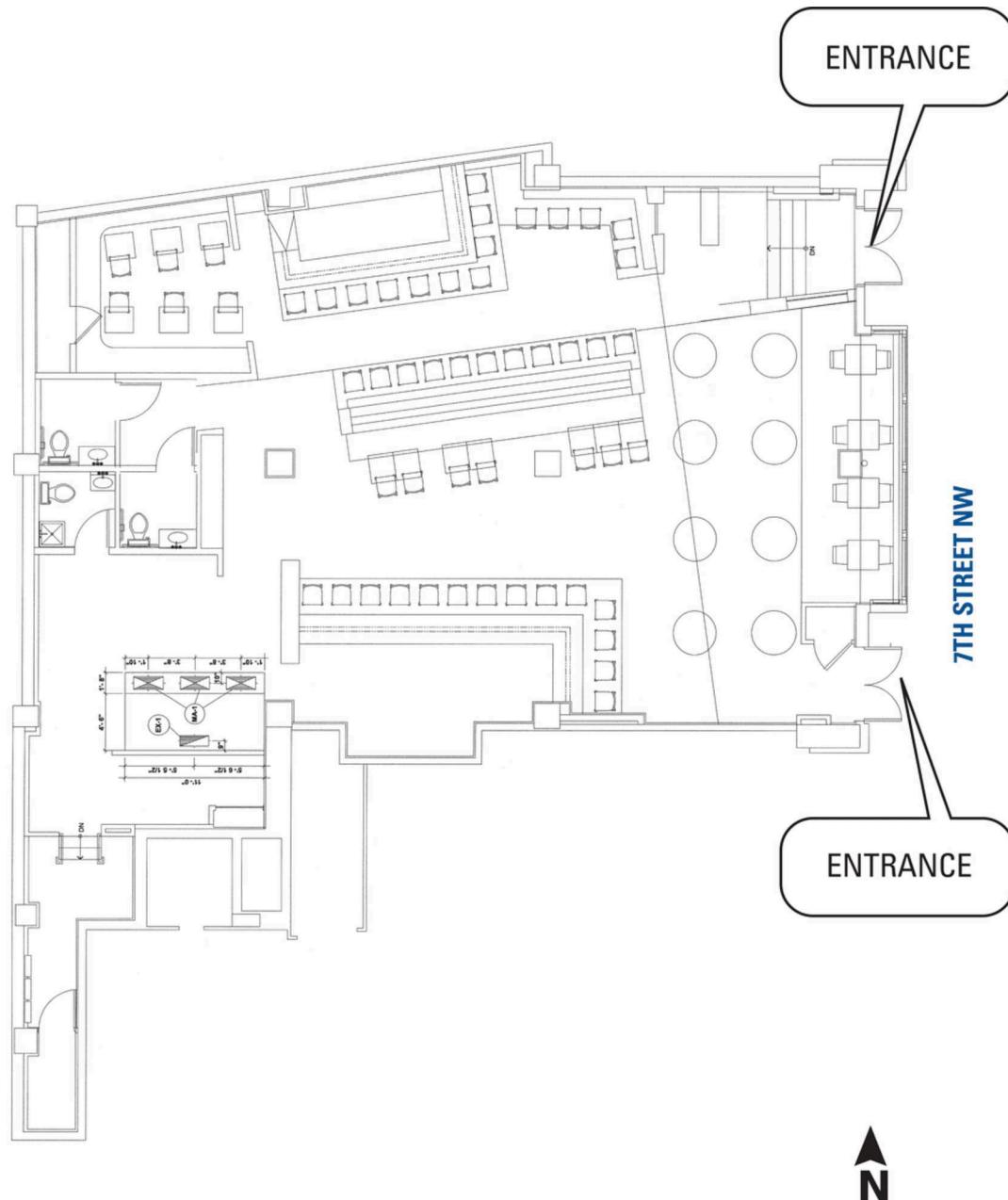

## 8TH AND E CORNER RETAIL SPACE

THE LANSBURGH | WASHINGTON, DC

2,965 SF 2ND GEN RESTAURANT SPACE AVAILABLE

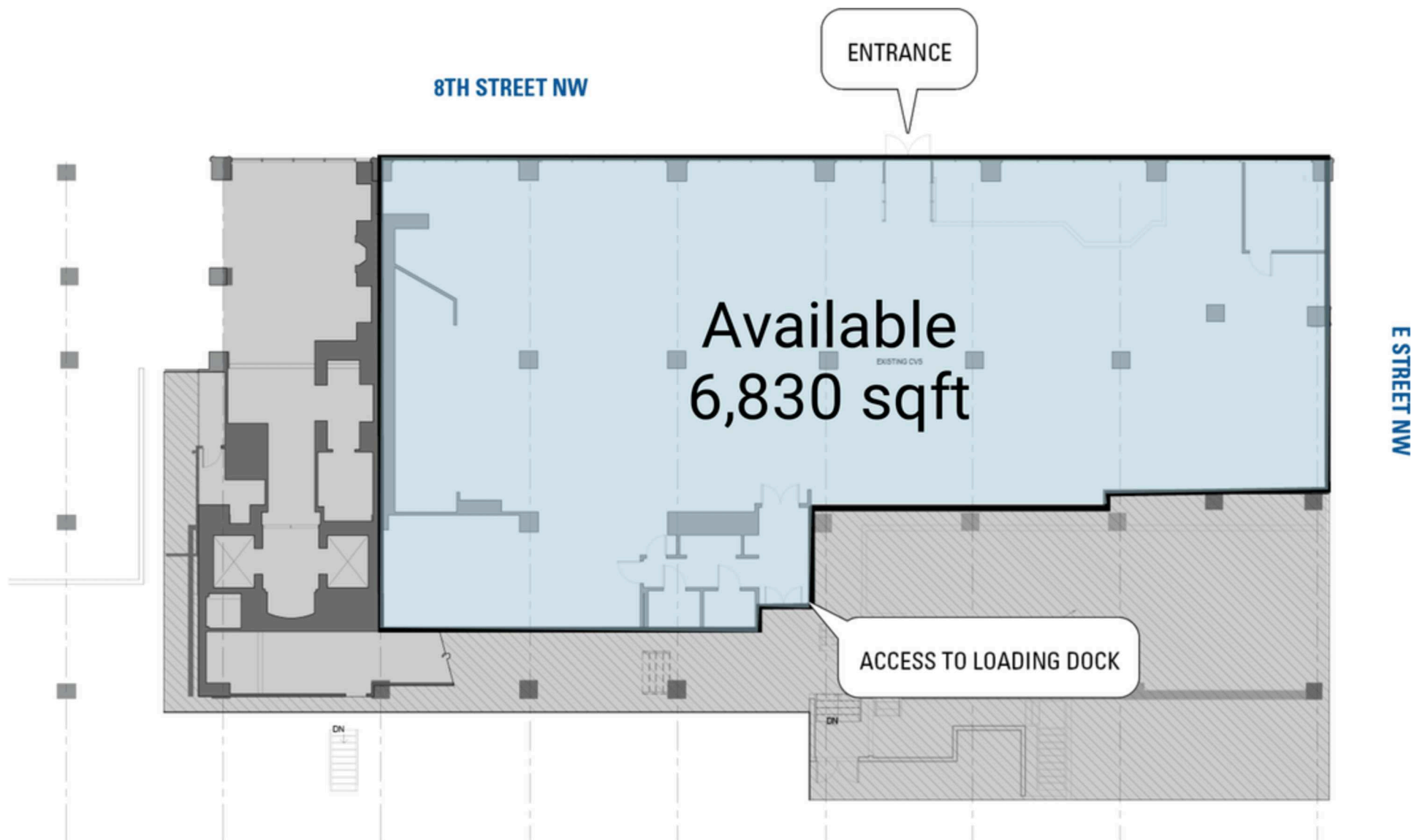



**THE LANSBURGH | 444 7TH ST NW, WASHINGTON, DC**

**Bill Dickinson | [bdickinson@rappaportco.com](mailto:bdickinson@rappaportco.com) | 703.310.6983**

**Mike Howard | [mhoward@rappaportco.com](mailto:mhoward@rappaportco.com) | 571.382.1219**

**Melissa Webb | [mwebb@rappaportco.com](mailto:mwebb@rappaportco.com) | 703.980.6829**

**[rappaportco.com](http://rappaportco.com)**