

THE LANSBURGH

WASHINGTON, DC

2,965-6,830 SF 2ND GEN RESTAURANT AND RETAIL SPACES AVAILABLE

RESERVED
APARTMENTS
AVAILABLE
★ ★ ★
202-393-1800

RAPPAPORT
CULTIVATING PLACES







THE LANSBURGH

WASHINGTON, DC

- | Retail and restaurant opportunity in the heart of Penn Quarter
- | Ample customer parking in building garage and central loading dock
- | Co-tenants include The Shakespeare Theater, Jaleo, China Chilcano, and Matchbox
- | One block from the National Mall, two blocks from Capital One Arena, and National Portrait Gallery

DEMOGRAPHICS 2024

	0.25 MILE	0.5 MILE	1 MILE
 POPULATION	2,094	8,974	38,460
 DAYTIME POPULATION	36,367	108,970	273,517
 HOUSEHOLD INCOME	\$202,132	\$154,316	\$129,871
 TRAFFIC COUNTS	22,475 on 7th Street NW		

AREA RETAILERS



**THE LANSBURGH
WASHINGTON, DC**

CITY CENTER



Dior
FIG & OLIVE
GUCCI
BVLGARI

DC CONVENTION CENTER

2.3M SF EVENT SPACE
1,027 CONVENTIONS IN 2016
~1 MILLION ATTENDEES

CARNEGIE LIBRARY



GALLERY PLACE



UNION STATION

31,000 METRO COUNTS



NEW YORK AVENUE

8TH STREET

H STREET

G STREET

MASSACHUSETTS AVENUE

700 13TH STREET NW



E STREET 7,527 VPD

7TH STREET NW 22,475 VPD

CAPITAL ONE ARENA

~2.4 MILLION ANNUALLY
20,000 SEATS



CAPITOL CROSSING

2.2M SF
75K SF RETAIL
8,000 NEW EMPLOYEES
(DAYTIME TRAFFIC)

THE CAPITOL



THE LANSBURGH BUILDING



PENNSYLVANIA AVENUE 13,747 VPD

NATIONAL MALL
33.8M VISITORS ANNUALLY

7TH STREET RESTAURANT OPPORTUNITY

THE LANSBURGH | WASHINGTON, DC

2,965 SF 2ND GEN RESTAURANT SPACE AVAILABLE

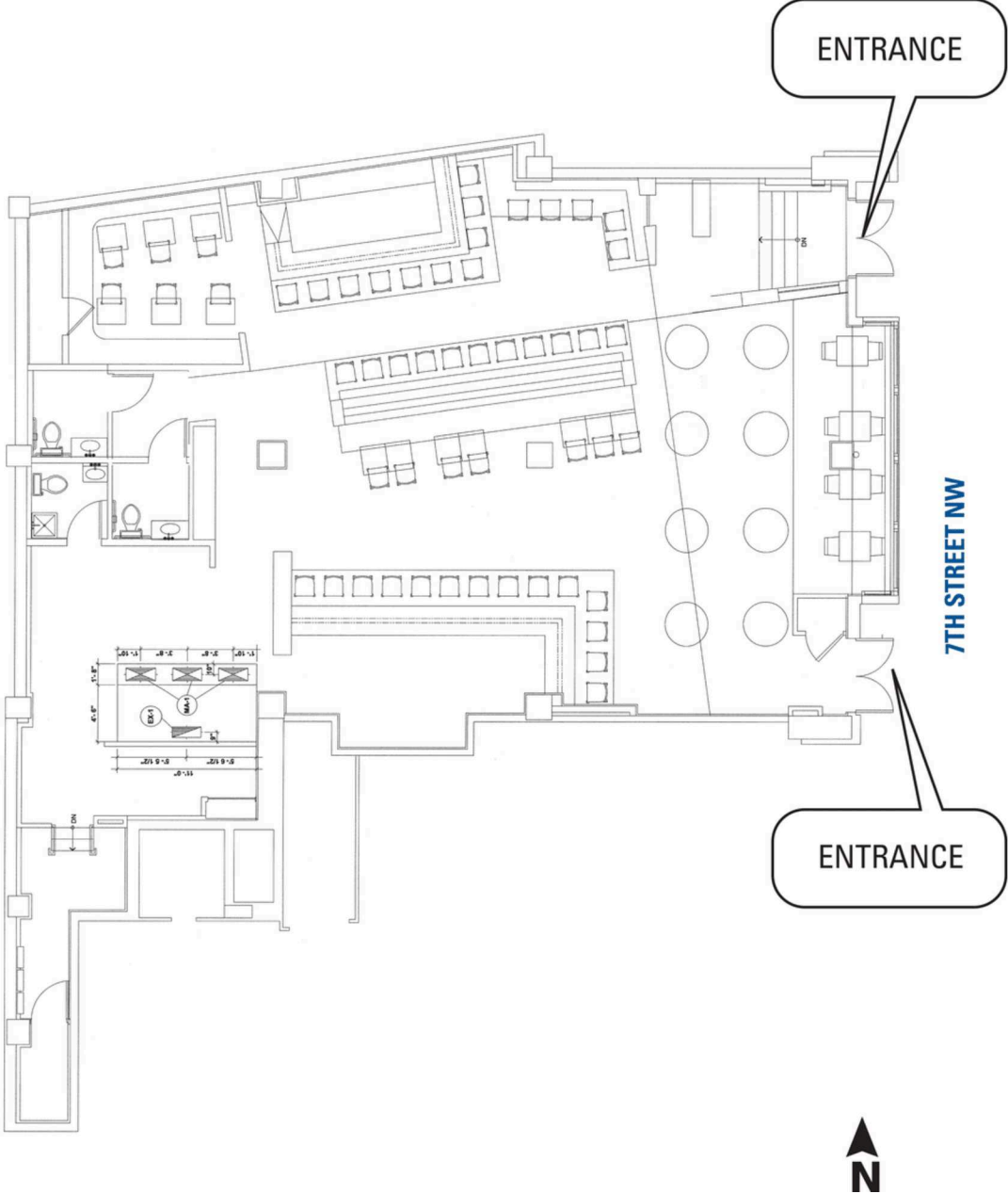

8TH AND E CORNER RETAIL SPACE

THE LANSBURGH | WASHINGTON, DC

2,965 SF 2ND GEN RESTAURANT SPACE AVAILABLE

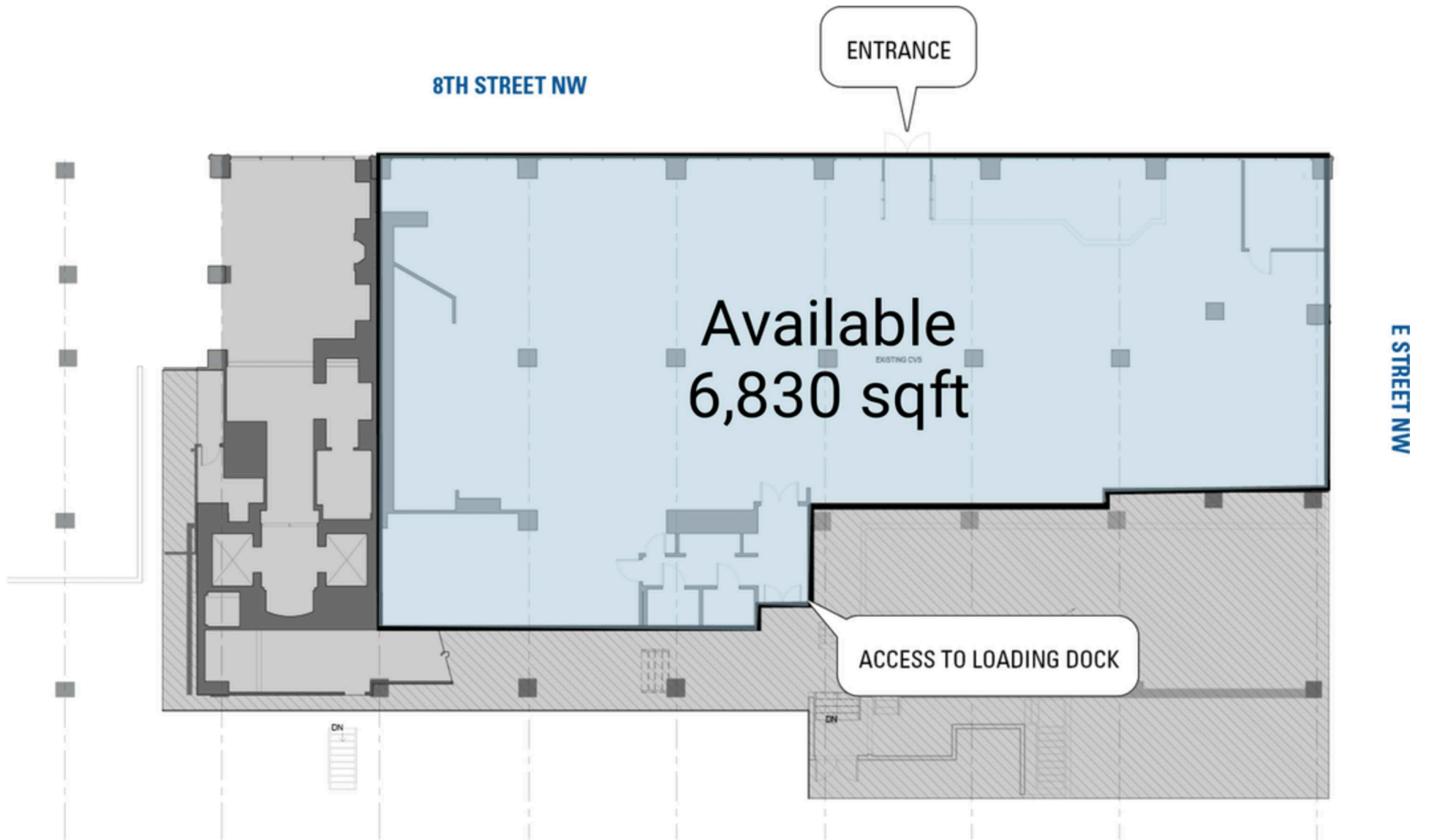



THE LANSBURGH | 444 7TH ST NW, WASHINGTON, DC

Bill Dickinson | bdickinson@rappaportco.com | 703.310.6983

Mike Howard | mhoward@rappaportco.com | 571.382.1219

Melissa Webb | mwebb@rappaportco.com | 703.980.6829

rappaportco.com