

2121 K STREET

WASHINGTON, DC

3,933 SF AVAILABLE WITH COOKING EXHAUST





RAPPAPORT
CULTIVATING PLACES



2121 K STREET WASHINGTON, DC

- | Second-generation restaurant space with black iron cooking exhaust and up to 203 SF available for storage
- | Streetfront retail space in a 190,458 SF Class A Office Building
- | Located in the heart of the CBD on K Street with 31,000 vehicles passing per day
- | Adjacent to George Washington University
- | In a highly affluent neighborhood where 53% of its population has earned a graduate degree

DEMOGRAPHICS 2024

	.25 MILE	.5 MILE	1 MILE
 POPULATION	3,461	22,095	54,596
 DAYTIME POPULATION	52,354	157,437	363,395
 HOUSEHOLD INCOME	\$94,074	\$125,240	\$154,452
 TRAFFIC COUNTS	31,200 on K Street NW Walk Score of 98 out of 100		

CO-TENANTS

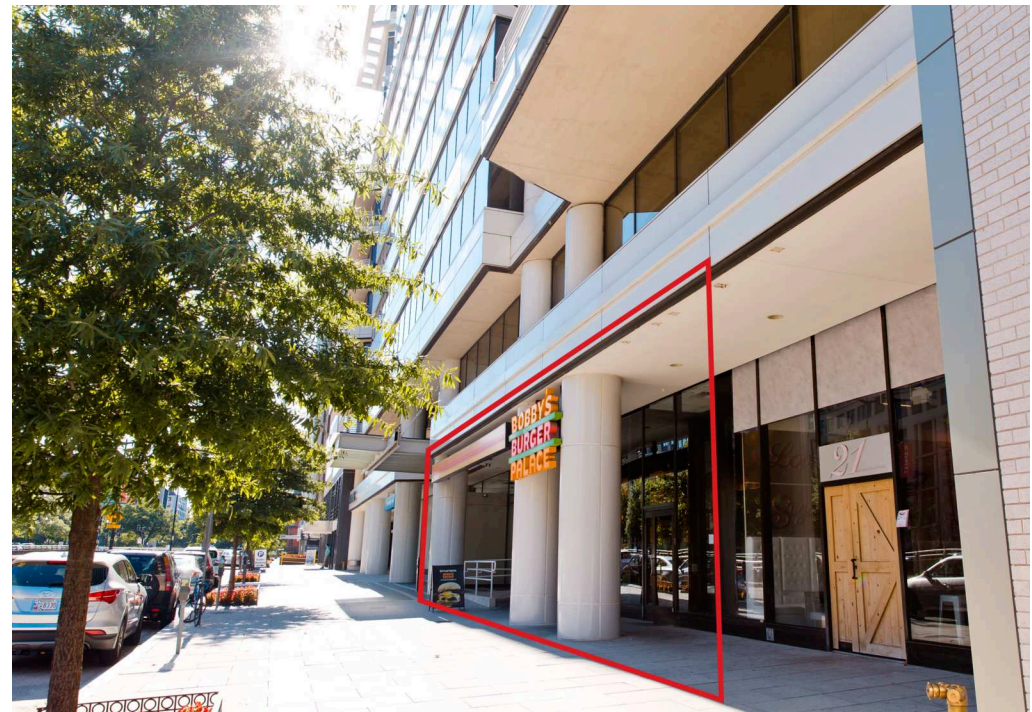

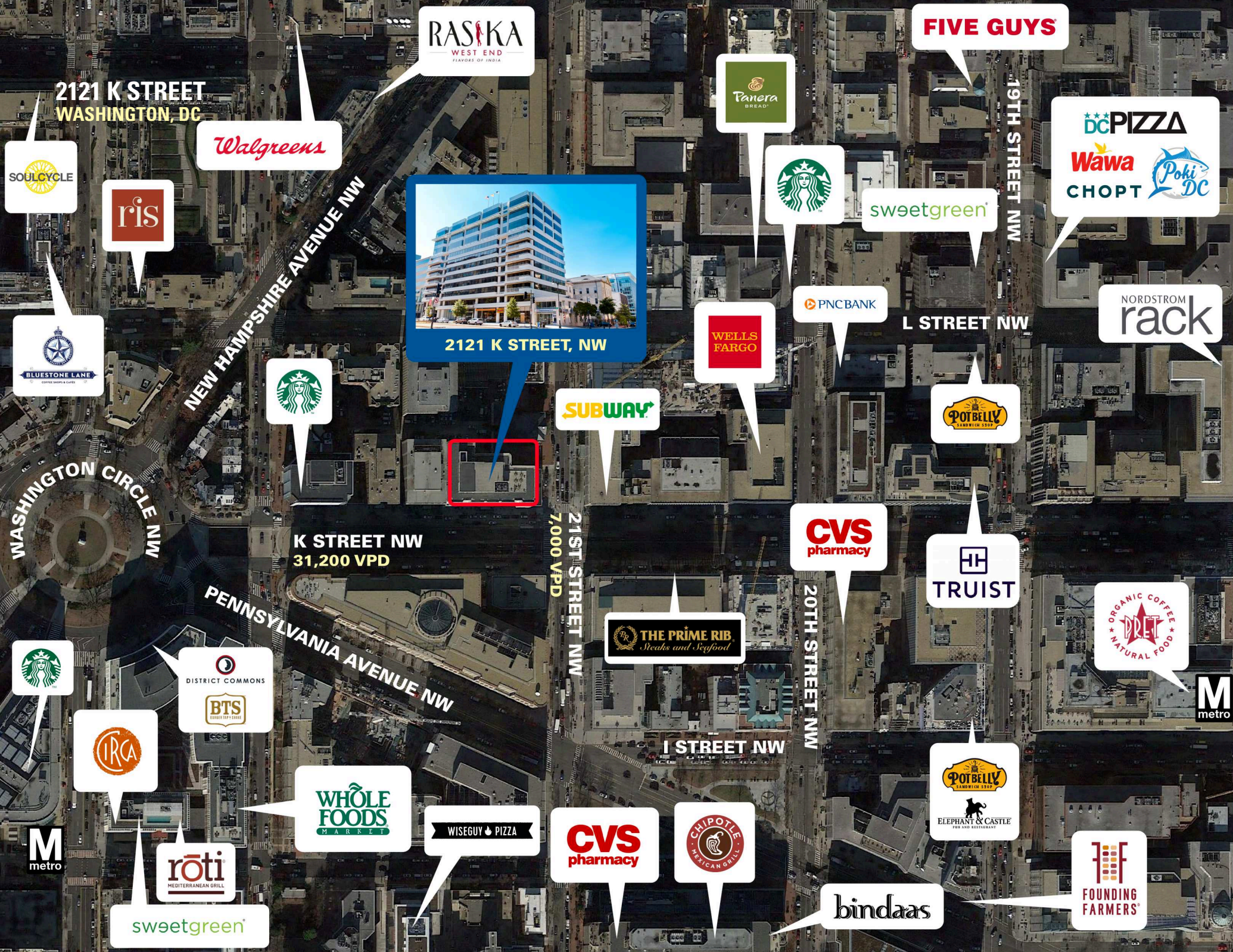

2121 K STREET
WASHINGTON, DC



Walgreens



NEW HAMPSHIRE AVENUE NW



2121 K STREET, NW



SUBWAY



sweetgreen

FIVE GUYS

19TH STREET NW



PNC BANK

L STREET NW

NORDSTROM
rack

WELLS
FARGO



WASHINGTON CIRCLE NW

K STREET NW
31,200 VPD

21ST STREET NW
7,000 VPD



CVS
pharmacy

TRUIST



WISEGUY PIZZA

CVS
pharmacy



20TH STREET NW



bindaas



sweetgreen



SITE PLAN

2121 K STREET | WASHINGTON, DC

3,933 SF AVAILABLE

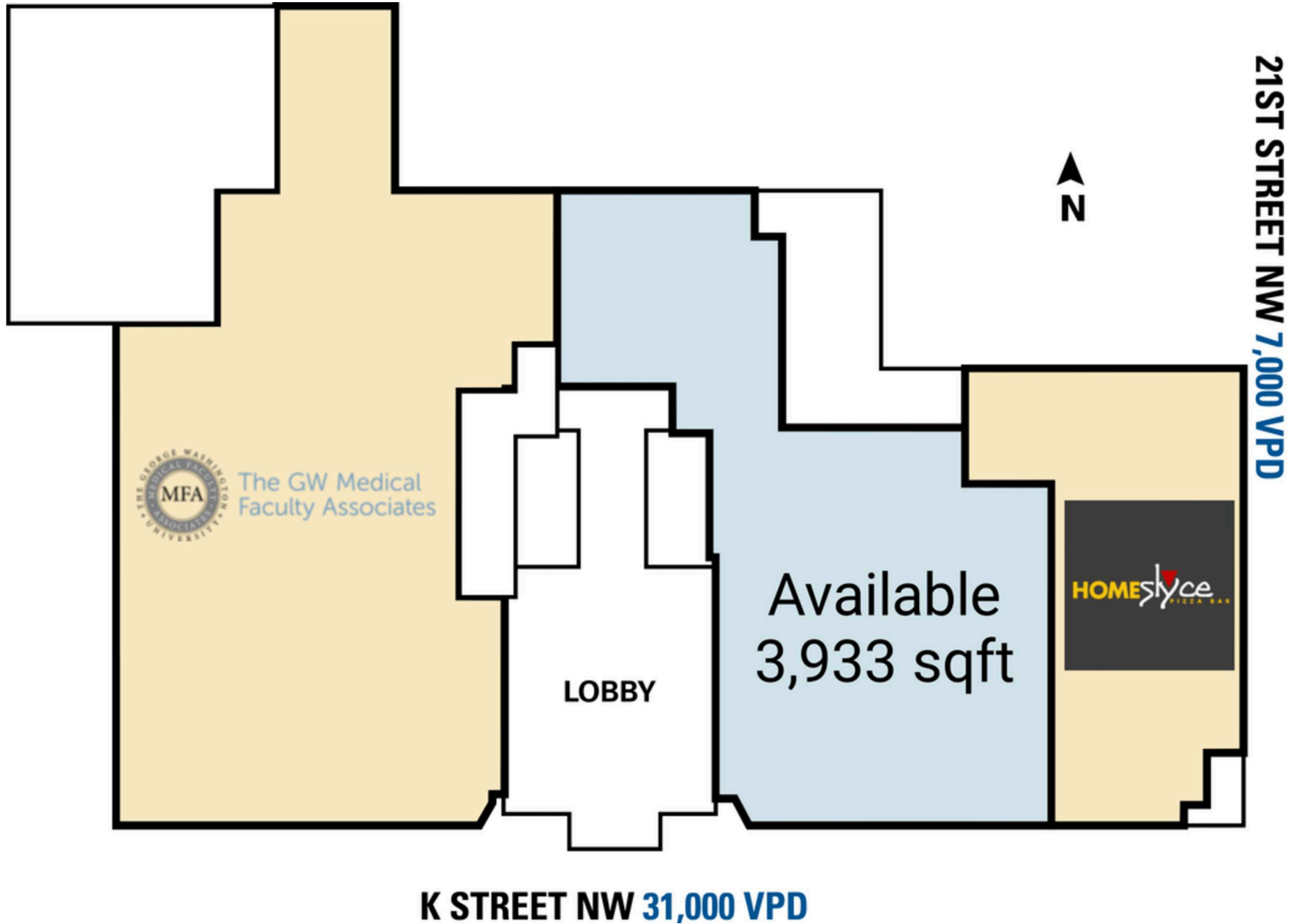



2121 K STREET | 2121 K STREET, WASHINGTON, DC

Mike Howard | mhoward@rappaportco.com | 571.382.1219

Melissa Webb | mwebb@rappaportco.com | 703.980.6829

Bill Dickinson | bdickinson@rappaportco.com | 703.310.6983

rappaportco.com