

# BETHESDA CROSSING

BETHESDA, MD

7315 WISCONSIN AVENUE

9,771 SF RETAIL SPACE

RAPPAPORT  
CULTIVATING PLACES









# BETHESDA CROSSING

## BETHESDA, MD

- | 9,771 SF street-front restaurant opportunity in the heart of affluent Bethesda
- | Highly visible from Wisconsin Avenue, the main roadway through the area, and within walking distance to the Bethesda Metro station
- | Just steps from several major hotel brands, such as Residence Inn by Marriott, Hyatt Regency, and Hilton Garden Inn, Marriott, and AC Hotel

### DEMOGRAPHICS 2024

	1 MILE	3 MILES	5 MILES
 POPULATION	26,841	152,969	494,525
 DAYTIME POPULATION	39,125	119,761	278,468
 HOUSEHOLD INCOME	\$204,646	\$237,657	\$178,645
 TRAFFIC COUNTS	35,176 on Wisconsin Avenue		

### AREA RETAILERS

Tatte  
BAKERY & CAFE

TACOMBI

MON AMI GABI  
A CLASSIC FRENCH BISTRO



LINCOLN





**BETHESDA CROSSING**  
BETHESDA, MD

**MARRIOTT**  
HEADQUARTERS

**E W HIGHWAY 14,716 VPD**

**CLUB PILATES®**  
**SOULCYCLE**  
**EQUINOX**  
**WELLS FARGO**  
**THE BALALUTA!**  
CASA and CANTINA

**M**  
metro  
**FOX 5**  
WASHINGTON DC  
HEADQUARTERS

**AC**  
HOTELS  
MARRIOTT

**LUKE'S**  
**Anthropologie**  
**FIVE GUYS** matchbox  
**THE SALT LINE** OYSTER SALE

**JALEO**  
BY JOE ANDRES  
**MON AMI GABI**  
A CLASSIC FRENCH BISTRO  
LANDMARK THEATRES

**WISCONSIN AVENUE 35,176 VPD**

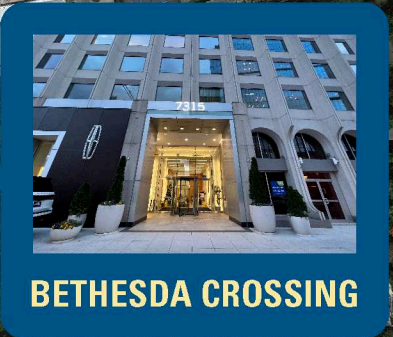

**Giant**

**Tatte**  
DESIGNS & COFFEE

**TRUE FOOD KITCHEN**

**WILLIAMS SONOMA**  
CALIFORNIA  
**THE NORTH FACE**

**PAUL**  
**CHOP'T**  
POTTERY BARN

**TACOMBI**

**CVS pharmacy**

**TRADER JOE'S**





**SITE PLAN: GROUND FLOOR**  
**BETHESDA CROSSING | BETHESDA, MD**  
**9,771 SF 2ND GEN RESTAURANT**

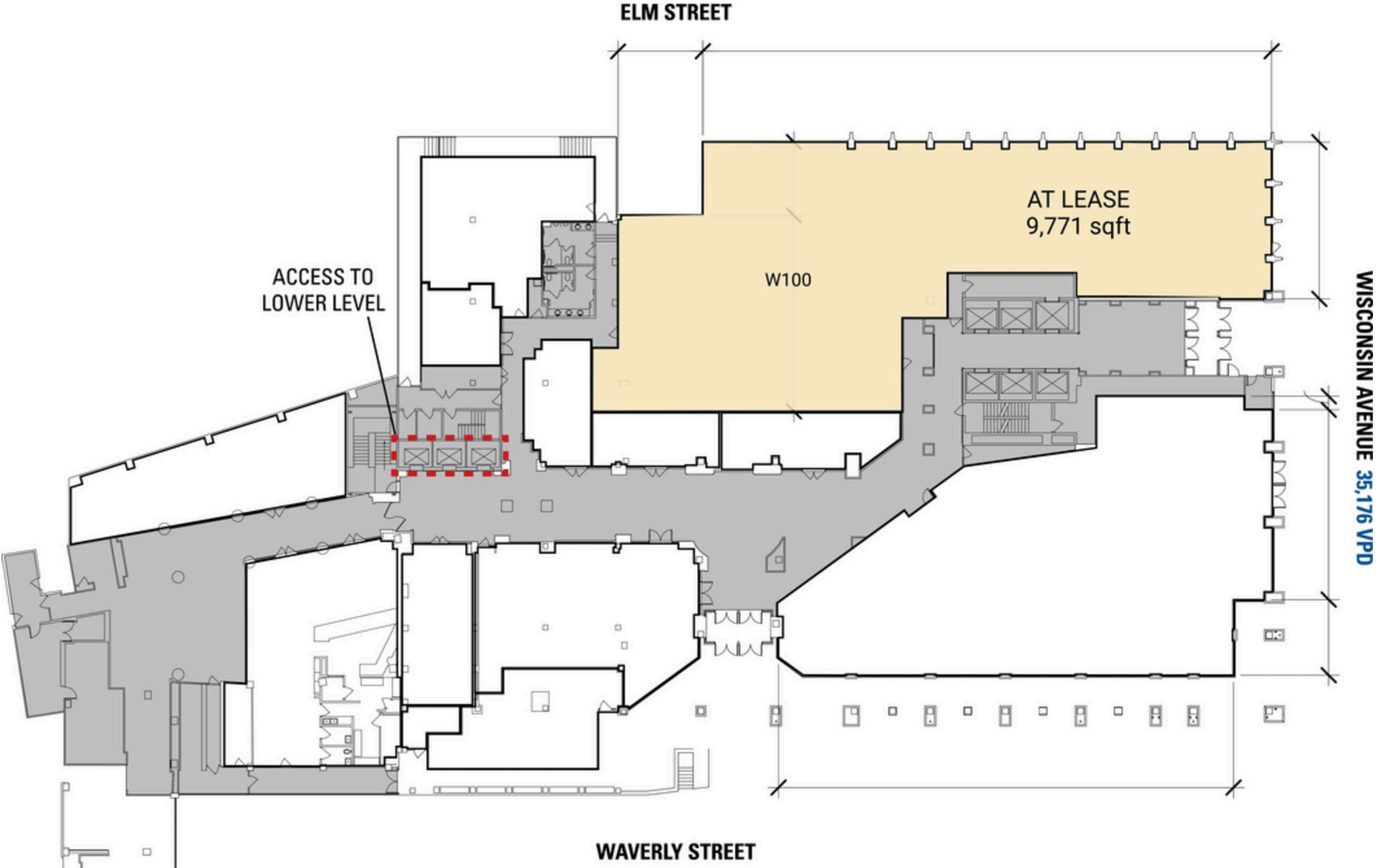

# RESTAURANT TEST FIT

BETHESDA CROSSING | BETHESDA, MD  
 9,771 SF 2ND GEN RESTAURANT

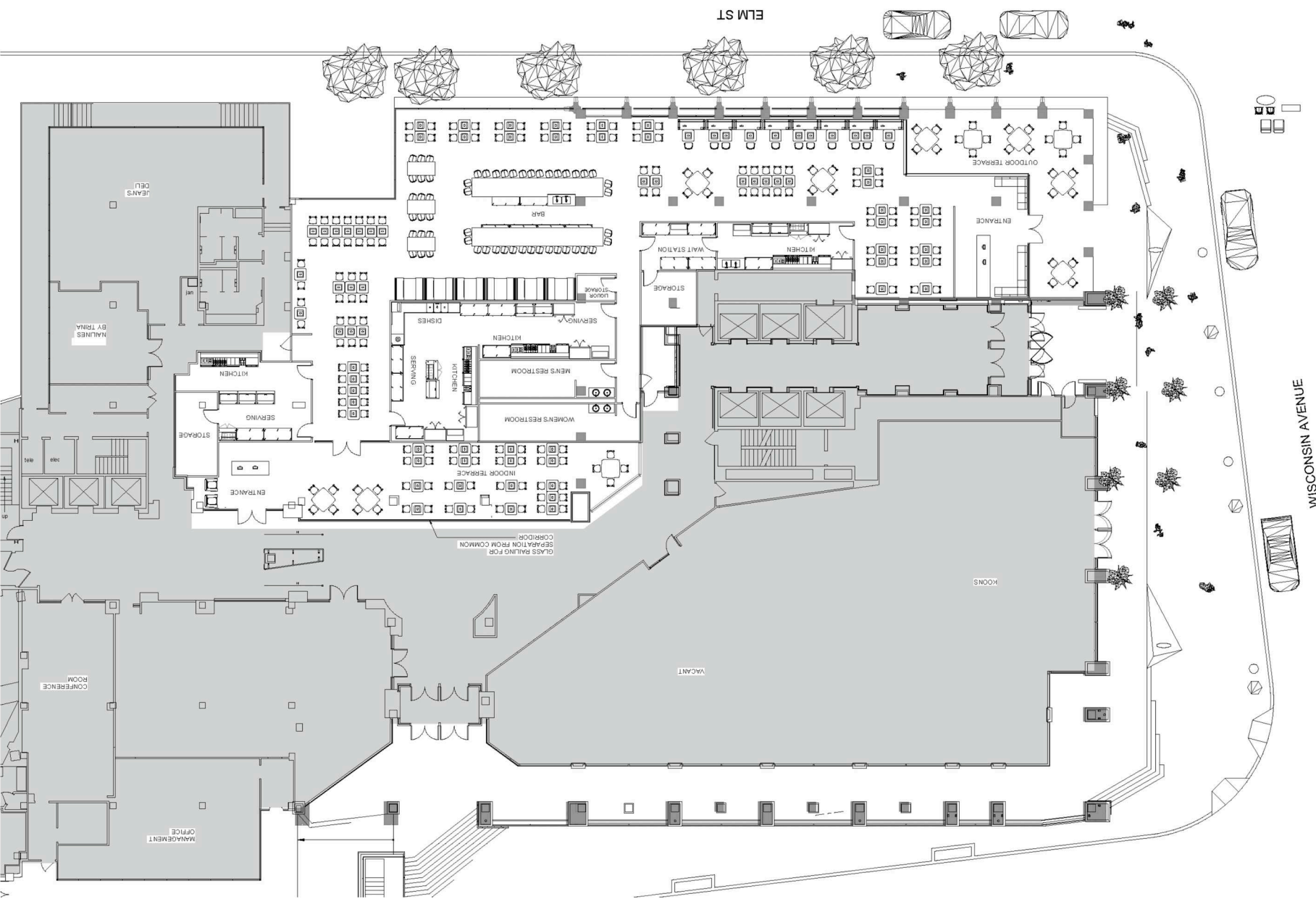



**7315 WISCONSIN AVENUE, BETHESDA, MD**

**Mike Howard | [mhoward@rappaportco.com](mailto:mhoward@rappaportco.com) | 571.382.1219**

**Pat O'Meara | [pomeara@rappaportco.com](mailto:pomeara@rappaportco.com) | 571.382.1218**

**[rappaportco.com](http://rappaportco.com)**