

WAVERLY VILLAGE





FREDERICKSBURG, VA
18,700 SF AVAILABLE



WAVERLY VILLAGE
FREDERICKSBURG, VA

- | 45,300 SF shopping center in the heart of Fredericksburg
- | Encompassing convenience and accessibility, residents, shoppers, and daytime professionals enjoy the blended tenant mix of essential, service, and dining offerings
- | Directly visible from Route 3 (Plank Road), this marketplace creates the ideal shopping experience through an abundance of parking, signage, and visibility

DEMOGRAPHICS 2025

	1 MILE	3 MILES	5 MILES
 POPULATION	4,482	54,851	128,961
 DAYTIME POPULATION	11,984	43,824	68,833
 HOUSEHOLD INCOME	\$112,351	\$89,704	\$99,752
 TRAFFIC COUNTS	80,000 on Plank Road (Rt. 3)		

CO-TENANTS



WAVERLY VILLAGE
FREDERICKSBURG, VA

centralpark
CORPORATE CENTER

**Office
DEPOT**
KOHL'S
BEST BUY

centralpark

BARNES & NOBLE BOOKSELLERS HOBBY LOBBY Starbucks BUFFALO WILD WINGS GRILL & BAR

OLD NAVY dressbarn five BELOW

TARGET OUTBACK STEAKHOUSE® Walmart Save money. Live better.

PET SMART

LOWE'S

95

REGAL ENTERTAINMENT GROUP

Wawa

Olive Garden ITALIAN KITCHEN

Pier 1 Imports

CAPOZZI

ROUTE 3

ROUTE 3

Gabe's

CAVA

Michaels

VCF VALUE CITY FURNITURE

at home The Home Décor Superstore

Starbucks

Chili's

Red Lobster

ROUTE 3

PLANK ROAD 76,000 VPD

BED BATH & BEYOND

95

THE HOME DEPOT

Wawa



WAVERLY VILLAGE

MATTRESS Warehouse

FedEx Office

PARAGON VILLAGE 12

SPOTSYLVANIA TOWNE CENTER

DICK'S SPORTING GOODS

WHITE|BLACK HOUSE MARKET

COSTCO WHOLESALE

★ macy's

EXPRESS

FIREBIRDS WOOD FIRED GRILL

ARHAUS your home

sears

SITE PLAN

WAVERLY VILLAGE | FREDERICKSBURG, VA

18,700 SF AVAILABLE

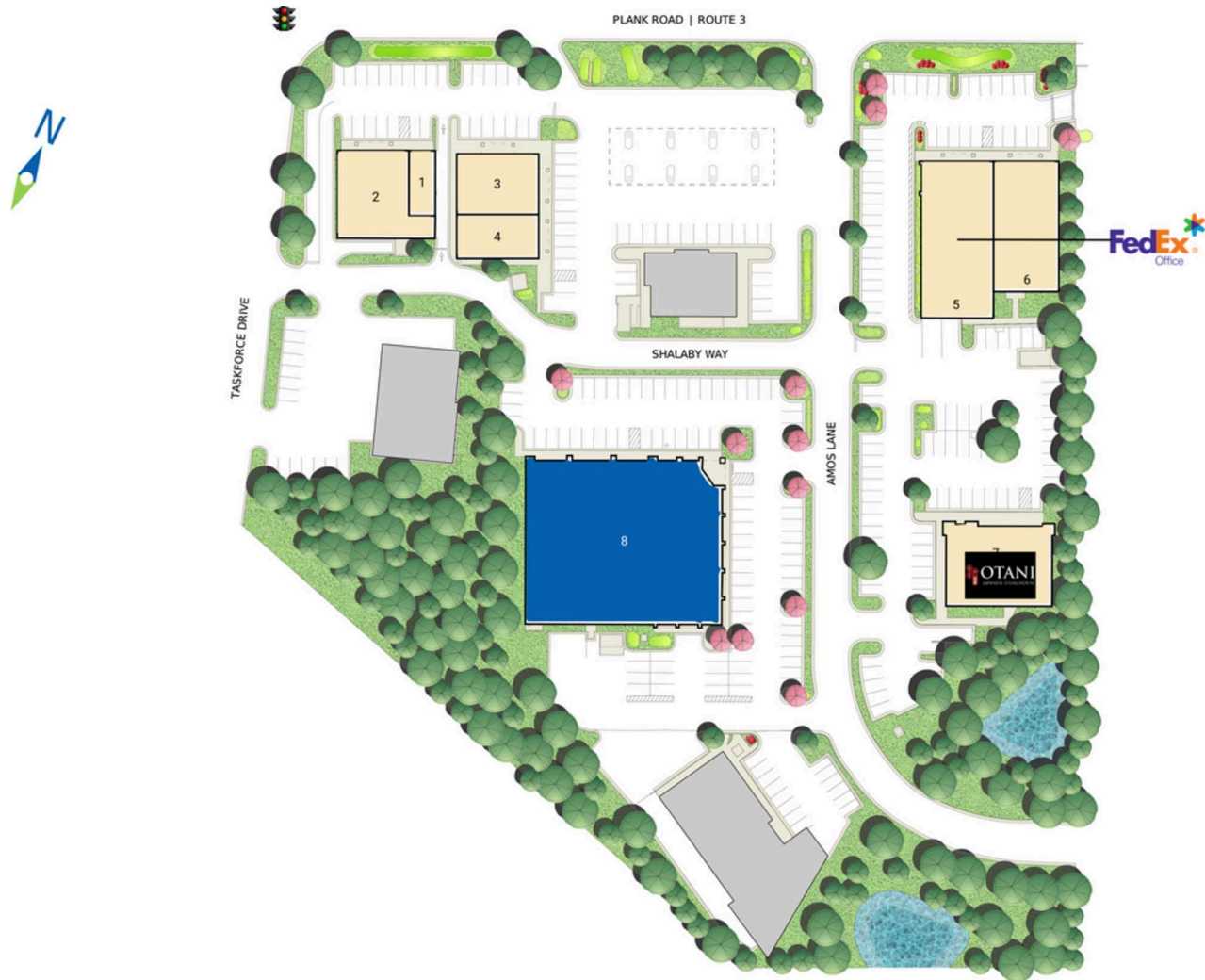

Space	Sq. Ft	Tenant Name	Space	Sq. Ft	Tenant Name	Space	Sq. Ft	Tenant Name
1	1,000	Deli Martinez	4	2,000	A+ Driving School	7	5,000	Otani Japanese Steak House
2	4,000	VKB Kitchen & Bath	5	6,600	FedEx Office	8	18,700	Available
3	3,000	Mattress Factory	6	5,000	Keep Active			



WAVERLY VILLAGE | 3546 PLANK ROAD, FREDERICKSBURG, VA

Susan Bourgeois | sbourgeois@rappaportco.com | 571.382.1288

rappaportco.com