

# 101 ENTERPRISE ST STERLING, VA

5,649 SF BUILDING ON 1.35 ACRES AVAILABLE

RAPPAPORT  
CULTIVATING PLACES









## 101 ENTERPRISE ST STERLING, VA

- | A 5,649 SF building on 1.35 acres available
- | Ample parking spaces available
- | Nearby retailers include McDonalds, Big Lots, Food Lion, Safeway, Goodwill, Home Value Furniture.

### DEMOGRAPHICS 2025

	1 MILE	3MILE	5 MILE
 POPULATION	18,376	97,839	252,572
 DAYTIME POPULATION	7,022	102,372	302,455
 HOUSEHOLD INCOME	\$127,594	\$146,976	\$152,474
 TRAFFIC COUNTS	20,998 on N Sterling Boulevard		

### AREA RETAILERS





**101 ENTERPRISE ST  
STERLING, VA**



WAXPOOL RD

ROUTE 7

**DULLES TOWN CENTER**

**POTOMAC RUN PLAZA**

**CEDAR LAKE PLAZA**

**SUGARLAND CROSSING**

**DULLES TOWN CROSSING**

**CLOCK TOWER CENTER**

**TOWN CENTER AT STERLING**

**DULLES 28**

**STERLING PLAZA**

**STERLING PARK SHOPPING MALL**

STERLING BLVD 201988 VPD

**Building Blocks Learning Academy**

DRANESVILLE ELEMENTARY



**101 ENTERPRISE ST**

285 FAIRFAX COUNTY PKWY

28 ROUTE 28

257 DULLES TOLL ROAD

DULLES AIRPORT

**OAK GROVE CENTER**

**ELDEN STREET MARKET PLACE**

ELDEN ST

**WORLDGATE CENTRE**

**RESTON TOWN CENTER**

**THE SPECTRUM**

**TARGET**

RESTON PKWY



# SITE PLAN

101 ENTERPRISE ST | STERLING, VA

5,649 SF AVAILABLE

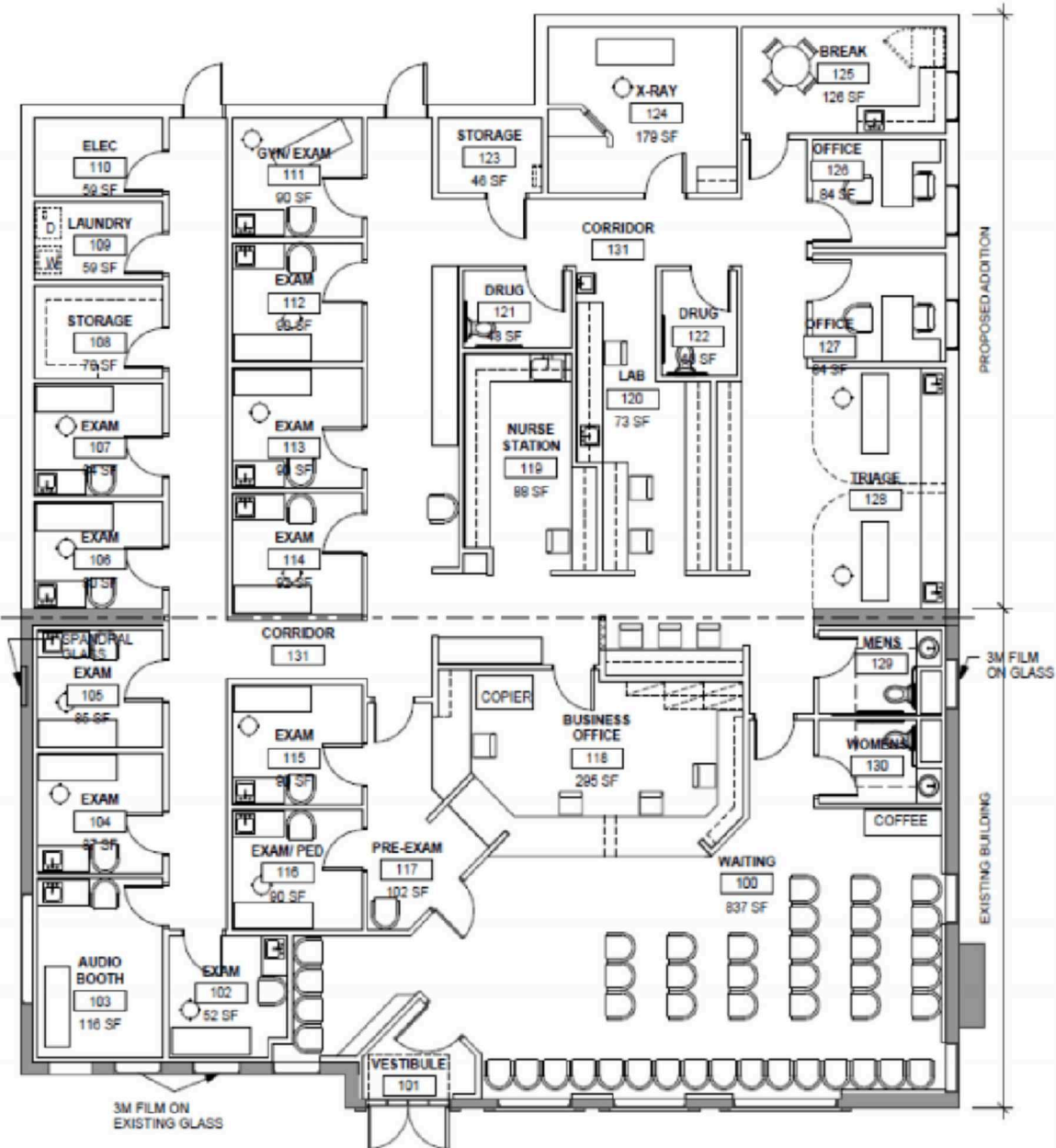

**101 ENTERPRISE ST**  
**STERLING, VA**





**101 ENTERPRISE ST, STERLING, VA**

**Mike Howard | [mhoward@rappaportco.com](mailto:mhoward@rappaportco.com) | 571.382.1219**

**[rappaportco.com](http://rappaportco.com)**