



The Lansburgh

Washington, DC

2,965-6,830 SF 2nd-gen restaurant
and retail spaces available



Washington

District of Columbia

- Retail and restaurant opportunity in the heart of Penn Quarter
- Ample customer parking in building garage and central loading dock
- Area retailers include The Shakespeare Theater, Jaleo, China Chilcano, and Matchbox
- One block from the National Mall, two blocks from Capital One Arena, and National Portrait Gallery



2025 Demographics

	0.25 mi.	0.5 mi.	1 mi.
Population	1,292	8,349	35,747
Daytime Population	11,872	149,094	218,216
Household Income	\$216,856	\$182,607	\$155,338
Traffic Counts	13,348 on 7th Street NW		

Area Retailers





7TH STREET RESTAURANT OPPORTUNITY

2,965 SF available

Space #	Sq. Ft.	Tenant
1	2,965	Available

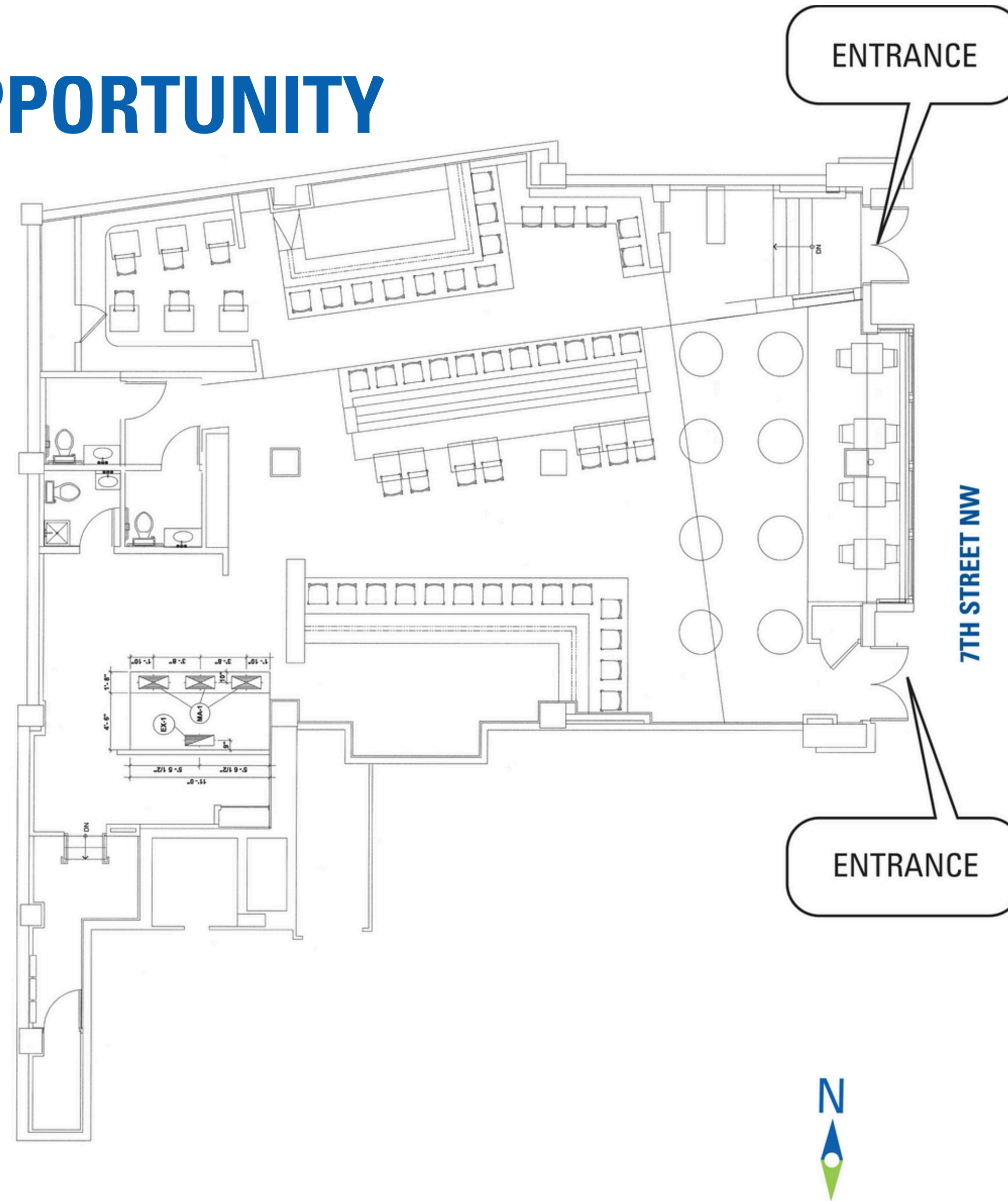

● Space Available

8TH AND E CORNER RETAIL SPACE

6,830 SF available

Space #	Sq. Ft.	Tenant
2	6,830	Available

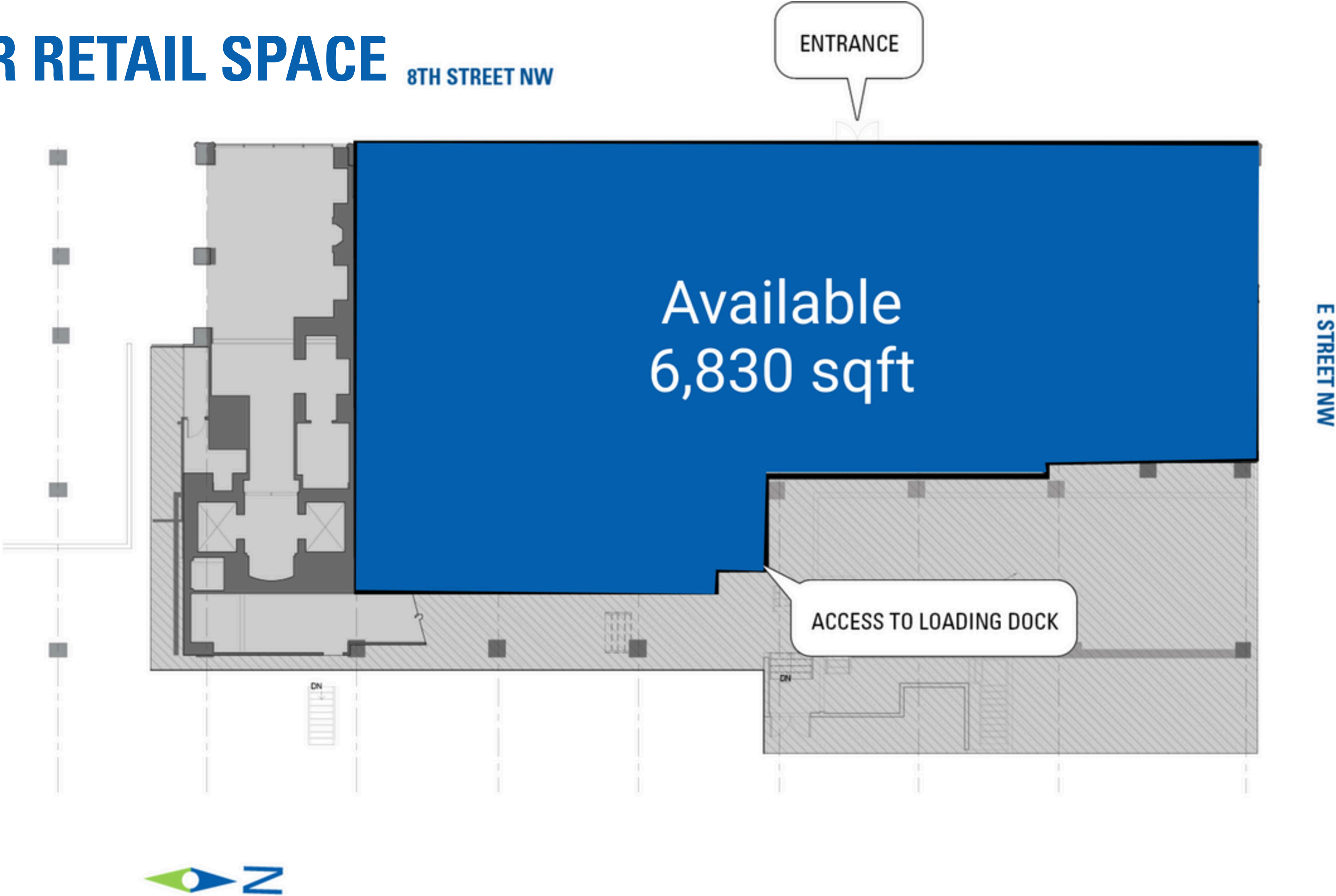

● Space Available

Discover your next retail opportunity at
rappaportco.com



WASHINGTON, D.C. | MARYLAND | VIRGINIA

THE LANSBURGH | 444 7TH ST NW, WASHINGTON, DC

Bill Dickinson | bdickinson@rappaportco.com | 703.310.6983

Mike Howard | mhoward@rappaportco.com | 571.382.1219

Melissa Webb | mwebb@rappaportco.com | 703.980.6829