



Adaire
McLean, VA

1,442 SF available



McLean

Virginia

Space in 400-unit high-rise located in developing Tysons Corner, with one of the largest retail concentrations in the region. The project is one of the tallest residential buildings in greater Washington with 35 floors (27 floors of residential) The location is highly accessible along Route 7 and to the Spring Hill Metro. The Adaire is one of the first phases of the Spring Hill Station development which will feature 1.3 million SF of office, 200,000 SF of retail and 4.4 million SF of residential.



2025 Demographics

	1 mi.	3 mi.	5 mi.
Population	18,132	94,174	232,024
Daytime Population	39,061	119,072	186,335
Household Income	\$194,386	\$33,844	\$234,637
Traffic Counts	75,200 on Route 7/Leesburg Pike		

Area Retailers





Site plan

1,442 SF available

Space #	Sq. Ft.	Tenant
1	1,442	Available
2	-	Club Pilates
3	-	Potbelly Sandwich Shop

● Space Available

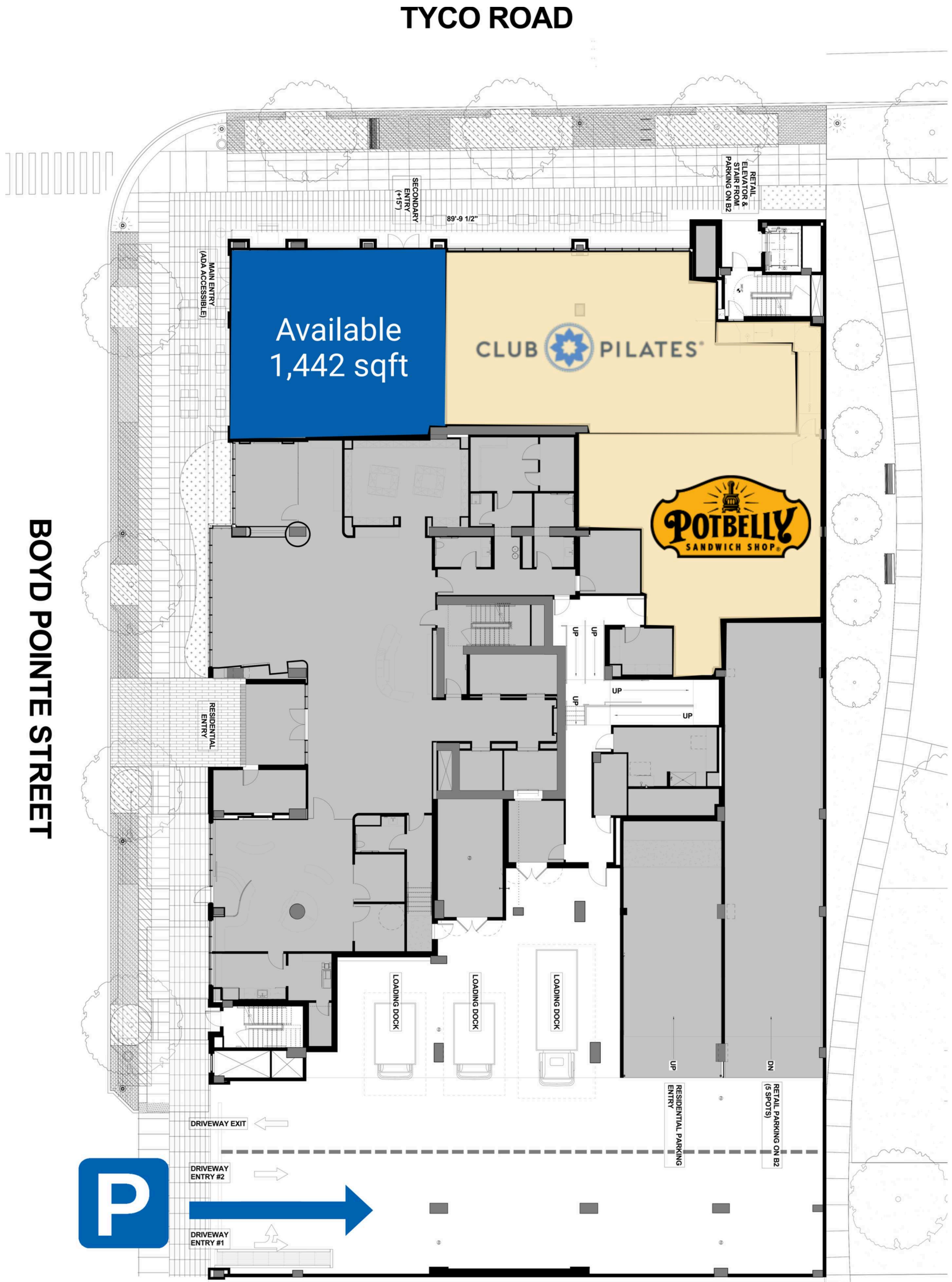

The Property



Discover your next retail opportunity at
rappaportco.com



WASHINGTON, D.C. | MARYLAND | VIRGINIA

ADAIRE | TYCO ROAD, MCLEAN, VA

Zach Elcano | zelcano@rappaportco.com | 571.382.1228