



RESA
Washington, DC

1,505 SF available



Washington

District of Columbia

- Situated directly along the NoMa Meander, a vibrant and welcoming four-block pedestrian walkway featuring retail, curated events, and a shared green space
- Conveniently located only 1 block from the NoMa-Gallaudet Metro Station
- Located in the densely populated NoMa neighborhood which boasts over 49,000 residents, 60,000 daytime employees, 1,501 hotel keys and 105,000 pedestrians daily
- Tremendous growth of demographics with over 7,800 residential units planned or currently under construction
- Located on the ground floor below a 326-unit luxury apartment building



2025 Demographics

	1 mi.	3 mi.	5 mi.
Population	75,543	394,450	819,249
Daytime Population	81,994	532,973	786,520
Household Income	\$168,233	\$168,517	\$155,521
Traffic Counts	36,000 on N Capitol Street NW		

Area Retailers



NOMA
WINE &
LIQUOR





Site Plan

1505 SF available

Space #	Sq. Ft.	Tenant
1	1828	Noma Wine & Liquor
2	1505	Available
3	4090	King Street Oyster Bar

● Space Available

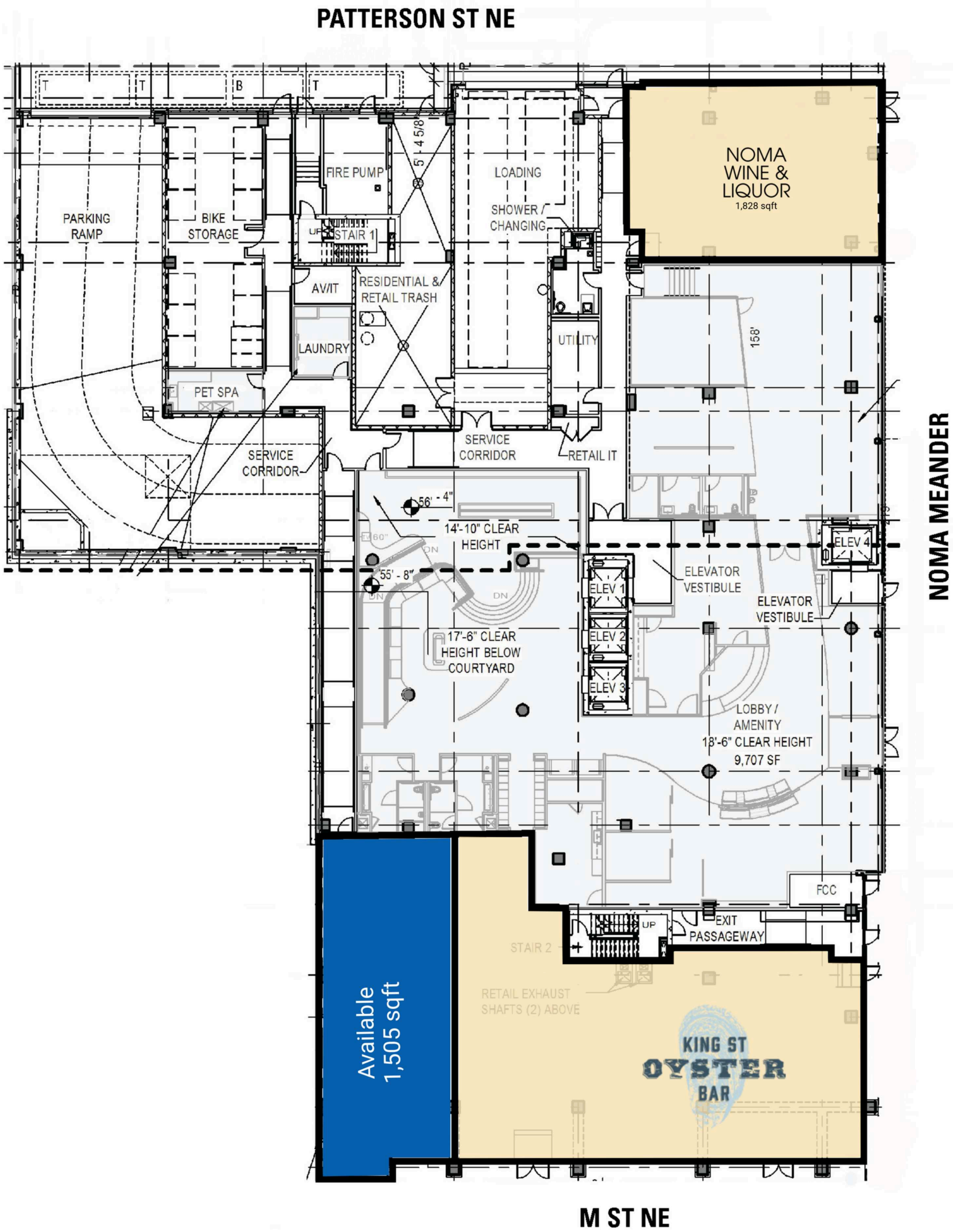

Discover your next retail opportunity at
rappaportco.com



WASHINGTON, D.C. | MARYLAND | VIRGINIA

RESA | 22 M STREET NE, WASHINGTON, DC

Mike Howard | mhoward@rappaportco.com | 571.382.1219

Kyle Gamber | kgamber@rappaportco.com | 571.382.1216