



**RESA**

Washington, DC

1,505 SF available

**RAPPAPORT**  
CULTIVATING PLACES





# Washington

District of Columbia

- Situated directly along the NoMa Meander, a vibrant and welcoming four-block pedestrian walkway featuring retail, curated events, and a shared green space
- Conveniently located only 1 block from the NoMa-Gallaudet Metro Station
- Located in the densely populated NoMa neighborhood which boasts over 49,000 residents, 60,000 daytime employees, 1,501 hotel keys and 105,000 pedestrians daily
- Tremendous growth of demographics with over 7,800 residential units planned or currently under construction
- Located on the ground floor below a 326-unit luxury apartment building



## 2026 Demographics

	1 mi.	3 mi.	5 mi.
Population	75,543	394,450	819,249
Daytime Population	81,994	532,973	786,520
Household Income	\$168,233	\$168,517	\$155,521
Traffic Counts	36,000 on N Capitol Street NW		

## Area Retailers



NOMA  
WINE &  
LIQUOR









# Site Plan

1,505 SF available

Space #	Sq. Ft.	Tenant
1	1,828	Noma Wine & Liquor
2	1,505	Available
3	4,090	King Street Oyster Bar

● Space Available

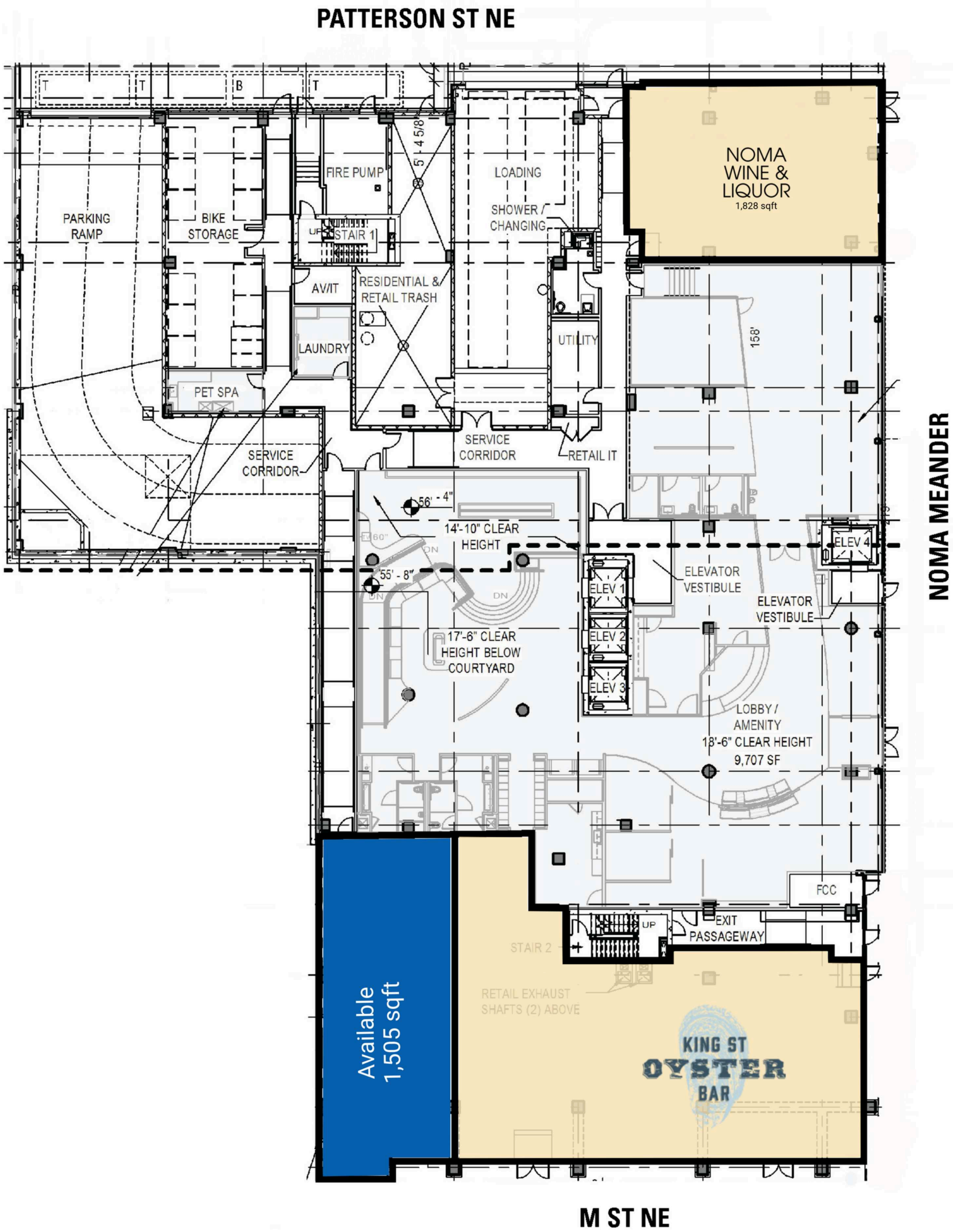

**Discover your next retail opportunity at**  
**rappaportco.com**



**WASHINGTON, D.C. | MARYLAND | VIRGINIA**

**RESA | 22 M STREET NE, WASHINGTON, DC**

**Mike Howard | mhoward@rappaportco.com | 571.382.1219**

**Kyle Gamber | kgamber@rappaportco.com | 571.382.1216**