



**NoMa CNTR**  
Washington, DC

2,745 - 3,177 SF available

**RAPPAPORT**  
CULTIVATING PLACES



# Washington

District of Columbia

- A mixed-use development featuring 40,000 SF of retail space which includes Ted's Bulletin, Gold's Gym, Uncorked Wine & Spirits, 500 residential units, and a 235 room Marriott hotel
- Vented restaurant spaces available
- NoMa is one of the fastest growing neighborhoods in DC, with over 14 million SF of office space, 8 hotels, and 7,800 residential units
- Total of 54,000 office employees with companies including CNN, Google, NPR, Sirius XM, and Department of Justice



## 2025 Demographics

	1 mi.	3 mi.	5 mi.
<b>Population</b>	68,236	391,916	818,282
<b>Daytime Population</b>	152,210	533,217	781,286
<b>Household Income</b>	\$169,068	\$165,917	\$152,888
<b>Traffic Counts</b>	8,566 on First Street NE		

## Area Retailers





NEW YORK AVENUE

PATTERSON STREET

M STREET

L STREET

K ST NE 19,000 VPD

NORTH CAPITOL STREET NW

FIRST STREET

FLORIDA AVENUE NE



NoMa CNTR



NoMa CNTR

RAPPAPORT CULTIVATING PLACES

# Level 1

2,745 - 3,177 SF available

Space #	Sq. Ft.	Tenant
1	4,924	Ted's Bulletin
4A	1,918	Metro Spice DC
4B	3,177	Available
4C	2,745	Available
5	2,913	At Lease
6	5,295	Uncorked Wine and Spirits

1ST STREET NE

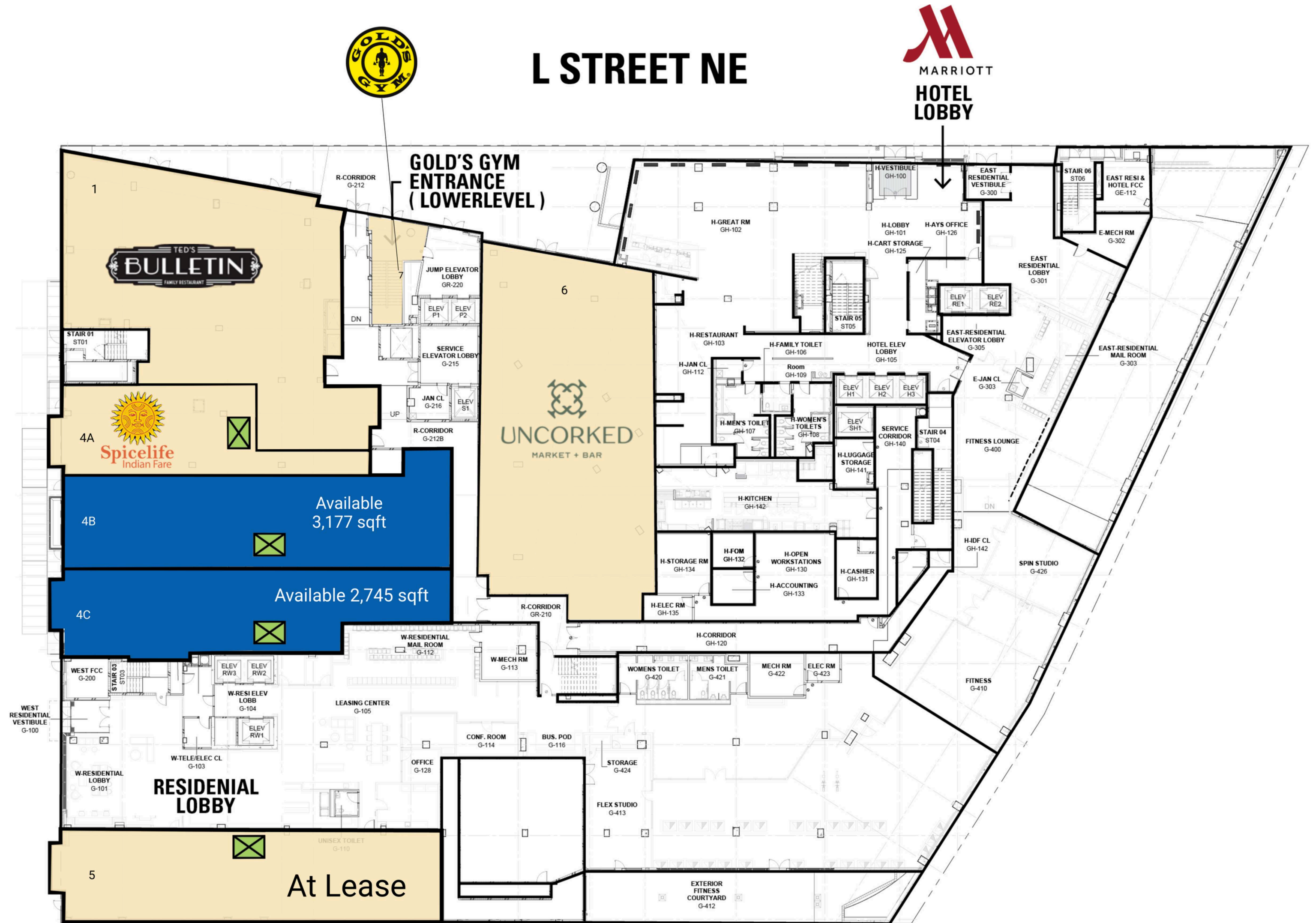

● Space Available

⊠ KITCHEN EXHAUST

# Lower Level

**Space #**  
2

**Sq. Ft.**  
16,800

**Tenant**  
Golds Gym

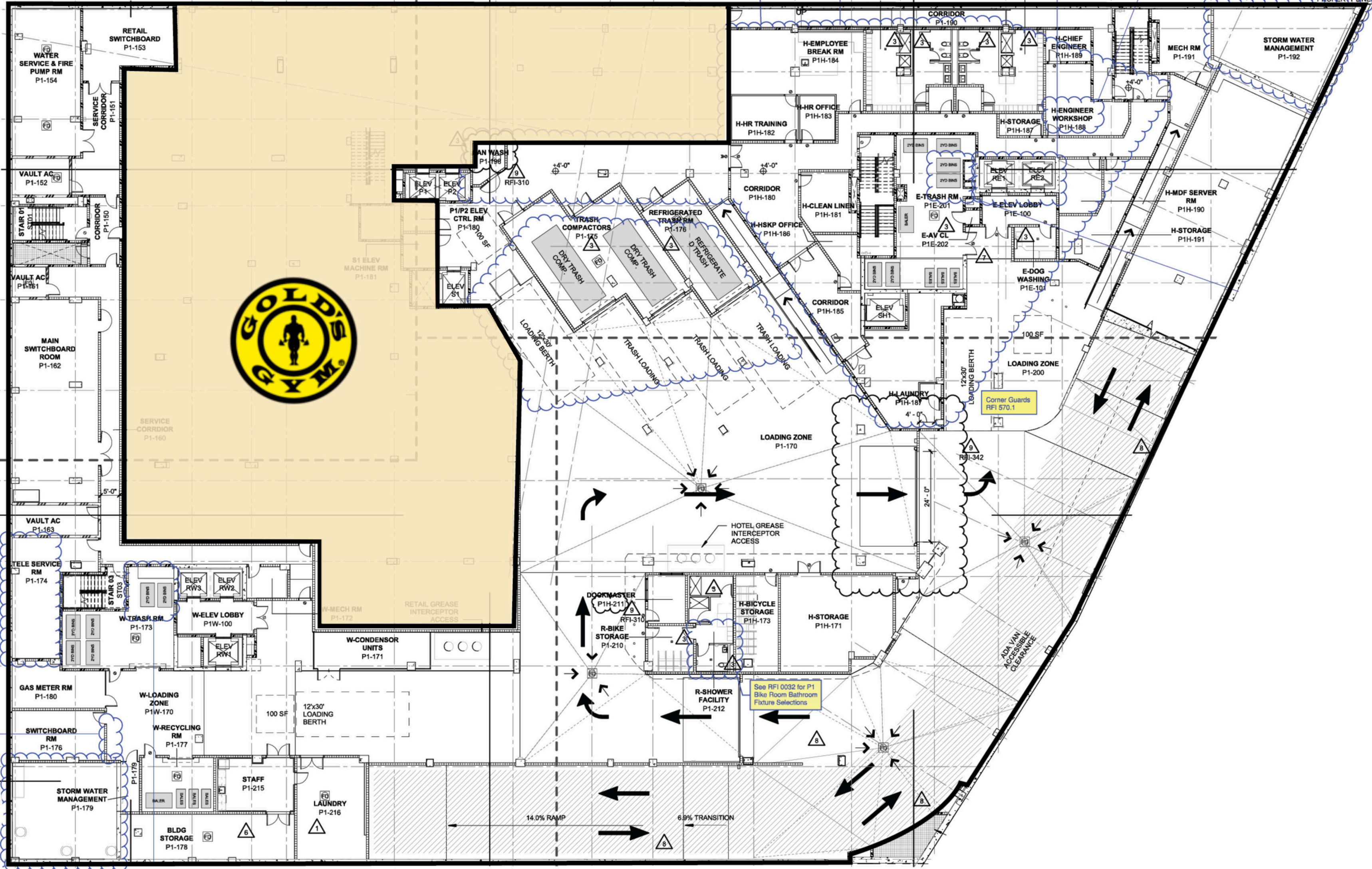

● Space Available

**Discover your next retail opportunity at**  
**rappaportco.com**



**WASHINGTON, D.C. | MARYLAND | VIRGINIA**

**NOMA CNTR | FIRST & L STREETS, NE, WASHINGTON, DC**

**Bill Dickinson | [bdickinson@rappaportco.com](mailto:bdickinson@rappaportco.com) | 703.310.6983**

**Melissa Webb | [mwebb@rappaportco.com](mailto:mwebb@rappaportco.com) | 703.980.6829**