



NoMa CNTR

Washington, DC

2,745 - 3,177 SF available

RAPPAPORT
CULTIVATING PLACES®

Washington

District of Columbia

- A mixed-use development featuring 40,000 SF of retail space which includes Ted’s Bulletin, Gold’s Gym, Uncorked Wine & Spirits, 500 residential units, and a 235 room Marriott hotel
- Vented restaurant spaces available
- NoMa is one of the fastest growing neighborhoods in DC, with over 14 million SF of office space, 8 hotels, and 7,800 residential units
- Total of 54,000 office employees with companies including CNN, Google, NPR, Sirius XM, and Department of Justice



2025 Demographics

	1 mi.	3 mi.	5 mi.
Population	68,236	391,916	818,282
Daytime Population	152,210	533,217	781,286
Household Income	\$169,068	\$165,917	\$152,888
Traffic Counts	8,566 on First Street NE		

Area Retailers





Level 1

2745 - 3177 SF available

Space #	Sq. Ft.	Tenant
1	4924	Ted's Bulletin
4A	1918	Metro Spice DC
4B	3177	Available
4C	2745	Available
5	2913	At Lease
6	5295	Uncorked Wine and Spirits

1ST STREET NE

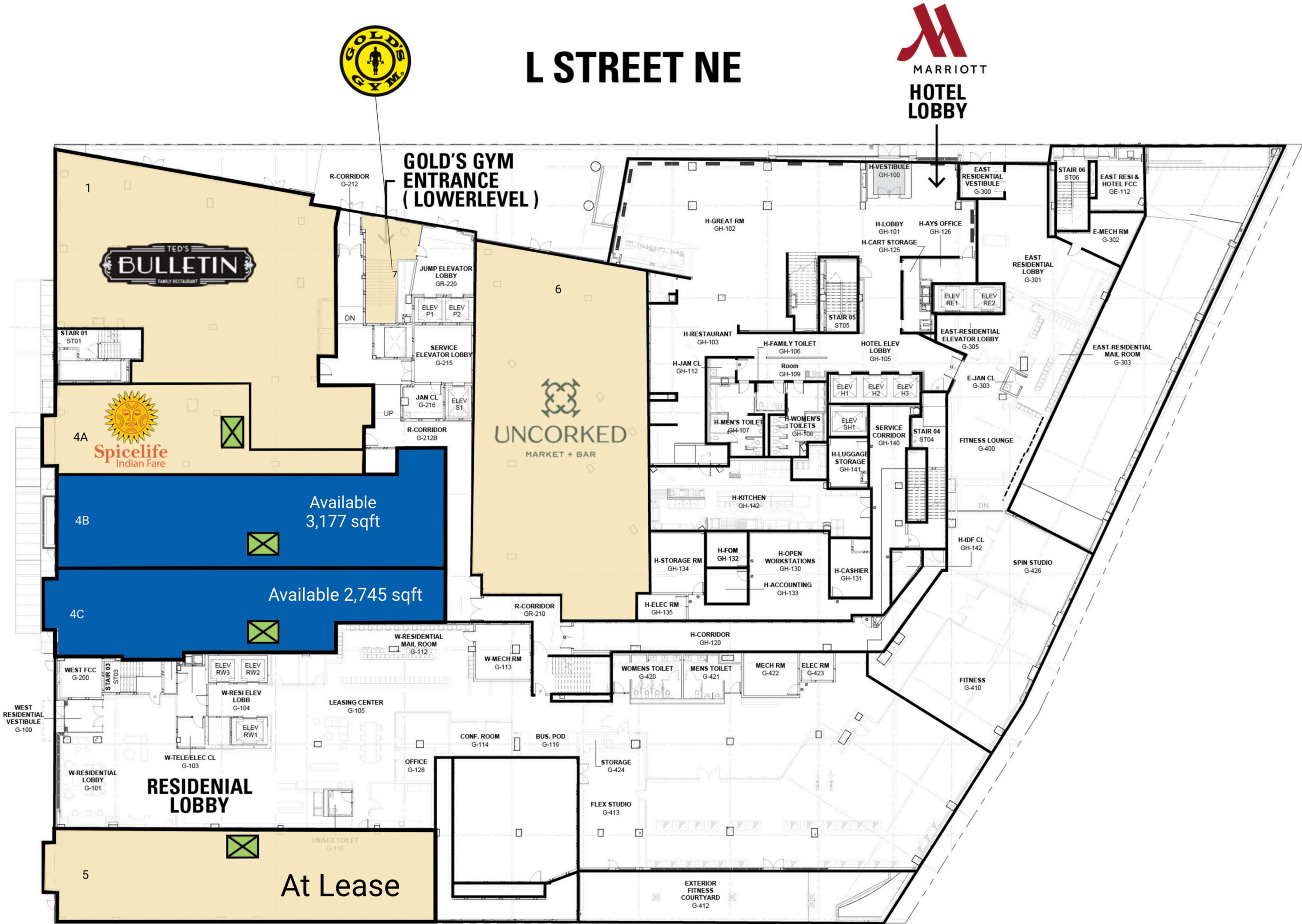

● Space Available

✕ KITCHEN EXHAUST

Lower Level

Space

2

Sq. Ft.

16800

Tenant

Golds Gym

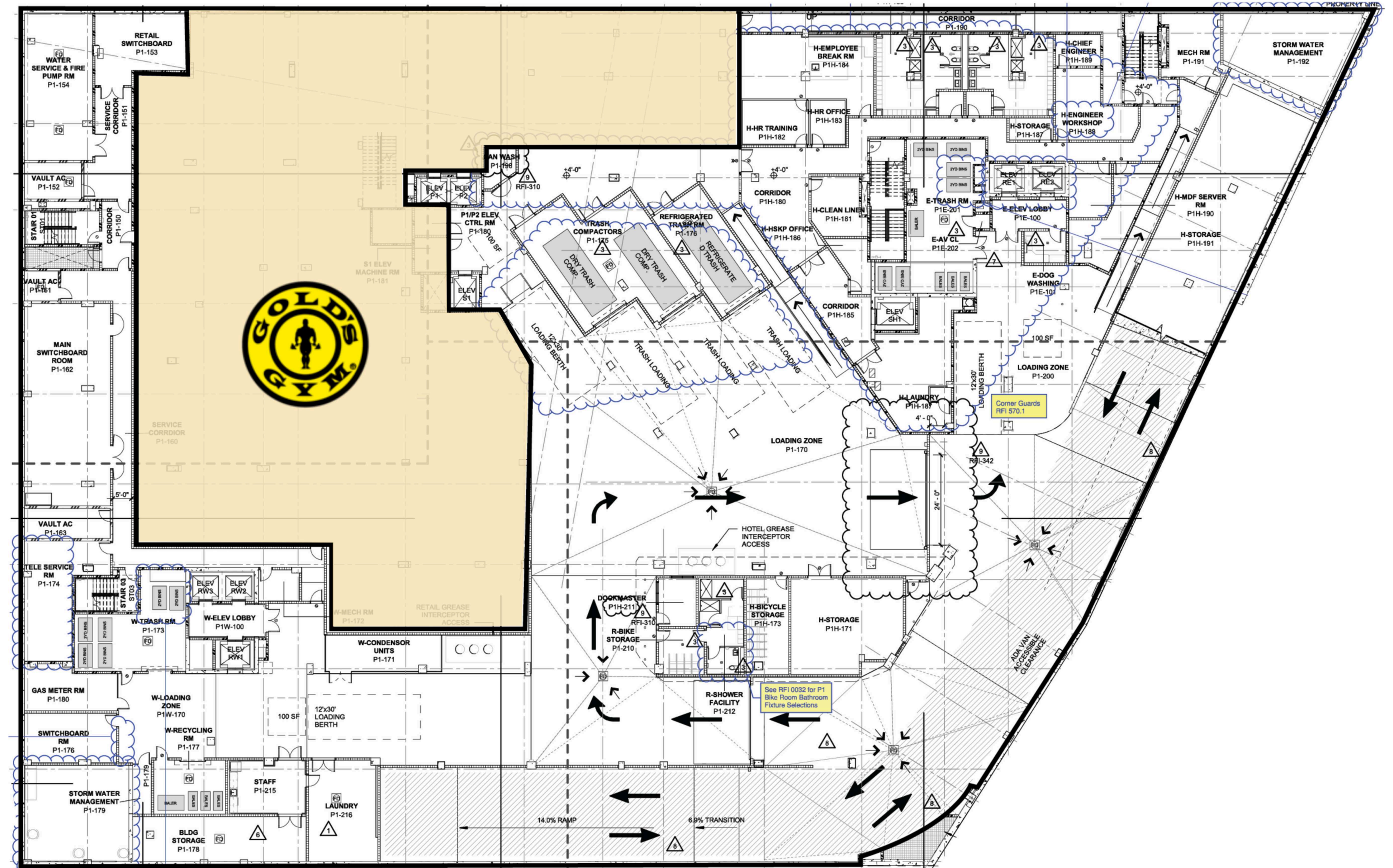

● Space Available

Discover your next retail opportunity at
rappaportco.com



WASHINGTON, D.C. | MARYLAND | VIRGINIA

NOMA CNTR | FIRST & L STREETS, NE, WASHINGTON, DC

Bill Dickinson | bdickinson@rappaportco.com | 703.310.6983

Melissa Webb | mwebb@rappaportco.com | 703.980.6829