



# Central Park Corporate Center

Fredericksburg, VA

Office Space Available



# Fredericksburg

Virginia

- A variety of office spaces available with an on-site property manager
- Data providers include Cox, Verizon, and Comcast
- Beautiful landscaping and well-maintained facilities with abundant parking
- Spectacular array of amenities, including restaurants, banking, shopping, fitness, and more
- Centrally located between Washington, D.C. and Richmond, just off I-95
- 15 bus routes offering great access to public transportation



## 2026 Demographics

	3 mi.	5 mi.	10 mi.
<b>Population</b>	52,126	135,449	225,469
<b>Daytime Population</b>	29,340	52,062	70,924
<b>Household Income</b>	\$119,340	\$126,657	\$134,558
<b>Traffic Counts</b>	80,000 on Central Park Blvd at Route 3		

## Area Retailers



# Ground Floor Site Plan

Spaces may be combined

Space #	Sq. Ft.	Tenant
108	9,745	Vascular Institute of Virginia
1320-100	18,121	Available
1420-101	2,213	Free Lance-Star Publishing
1420-103	2,100	Club Pilates
1420-110	8,485	Minnieland Private Daycare
1440-100A	2,859	Available
1440-100B	4,139	Available
1440-100C	1,980	New Century Hospice, Inc.
1440-104	2,260	Lendmark Financial Services



# Upper Floor Site Plan

Spaces may be combined



FOURTH LEVEL PLAN

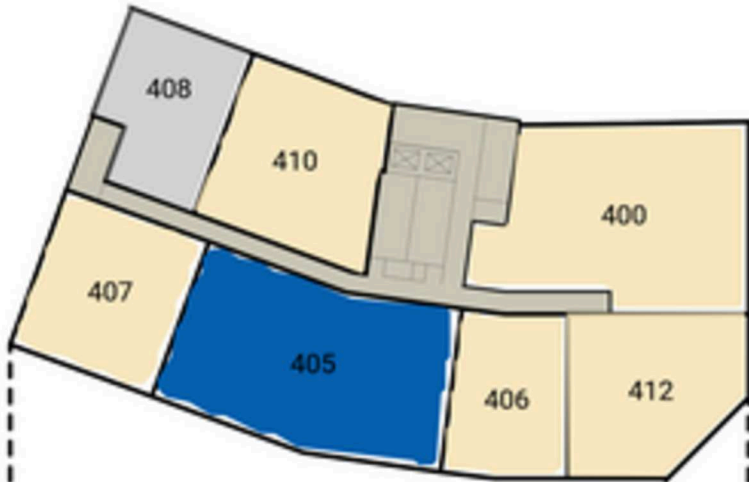

THIRD LEVEL PLAN

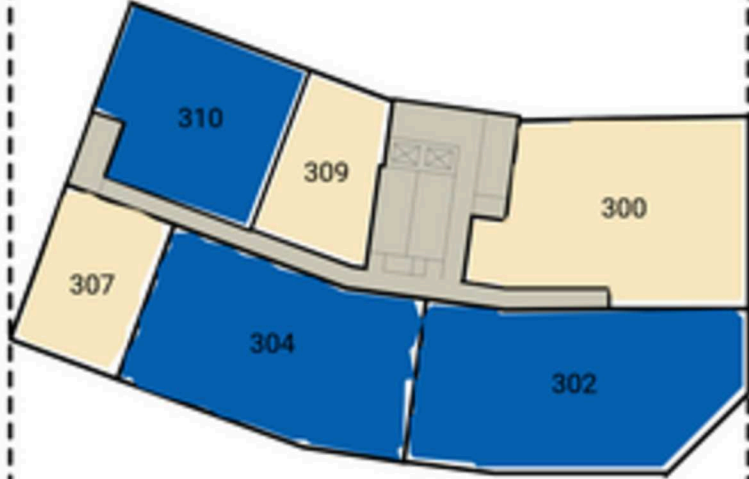

SECOND LEVEL PLAN

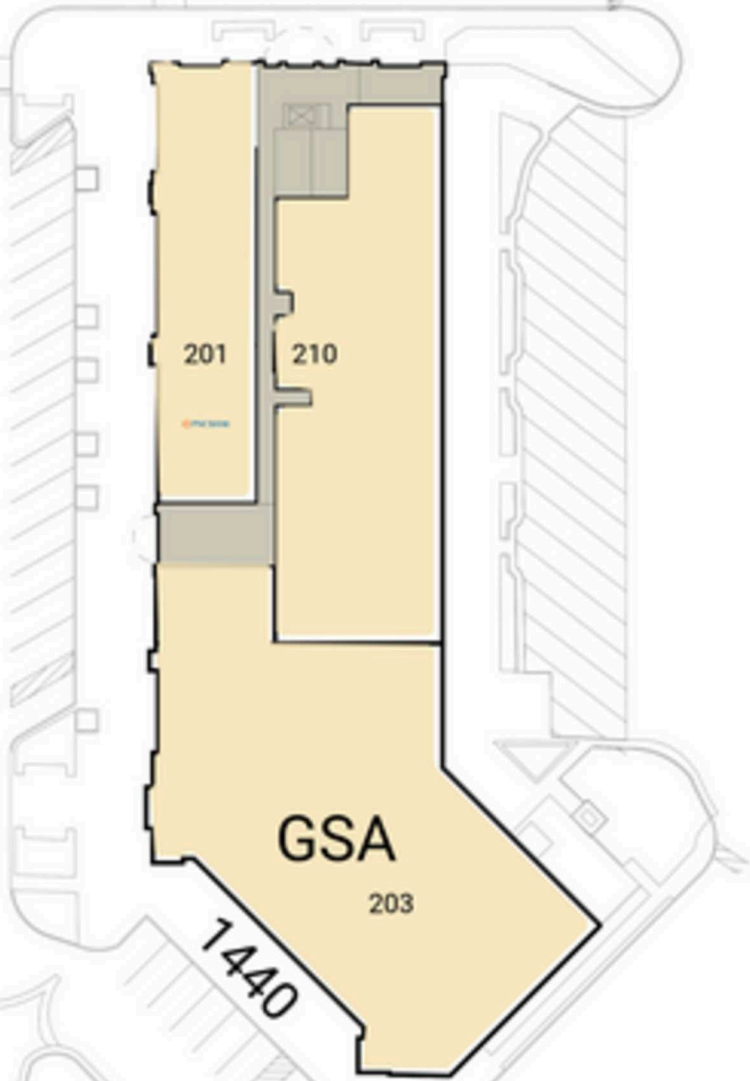
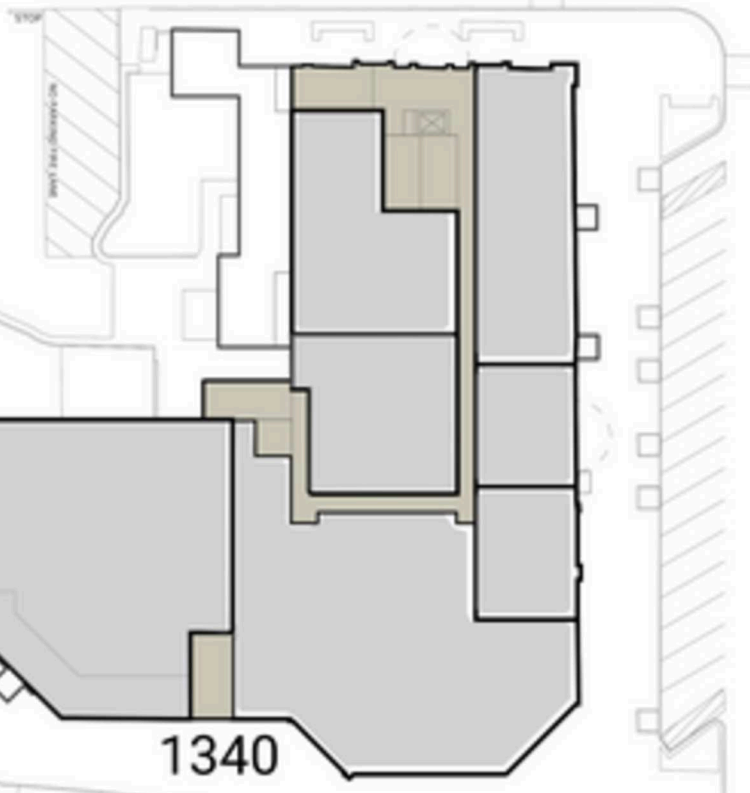
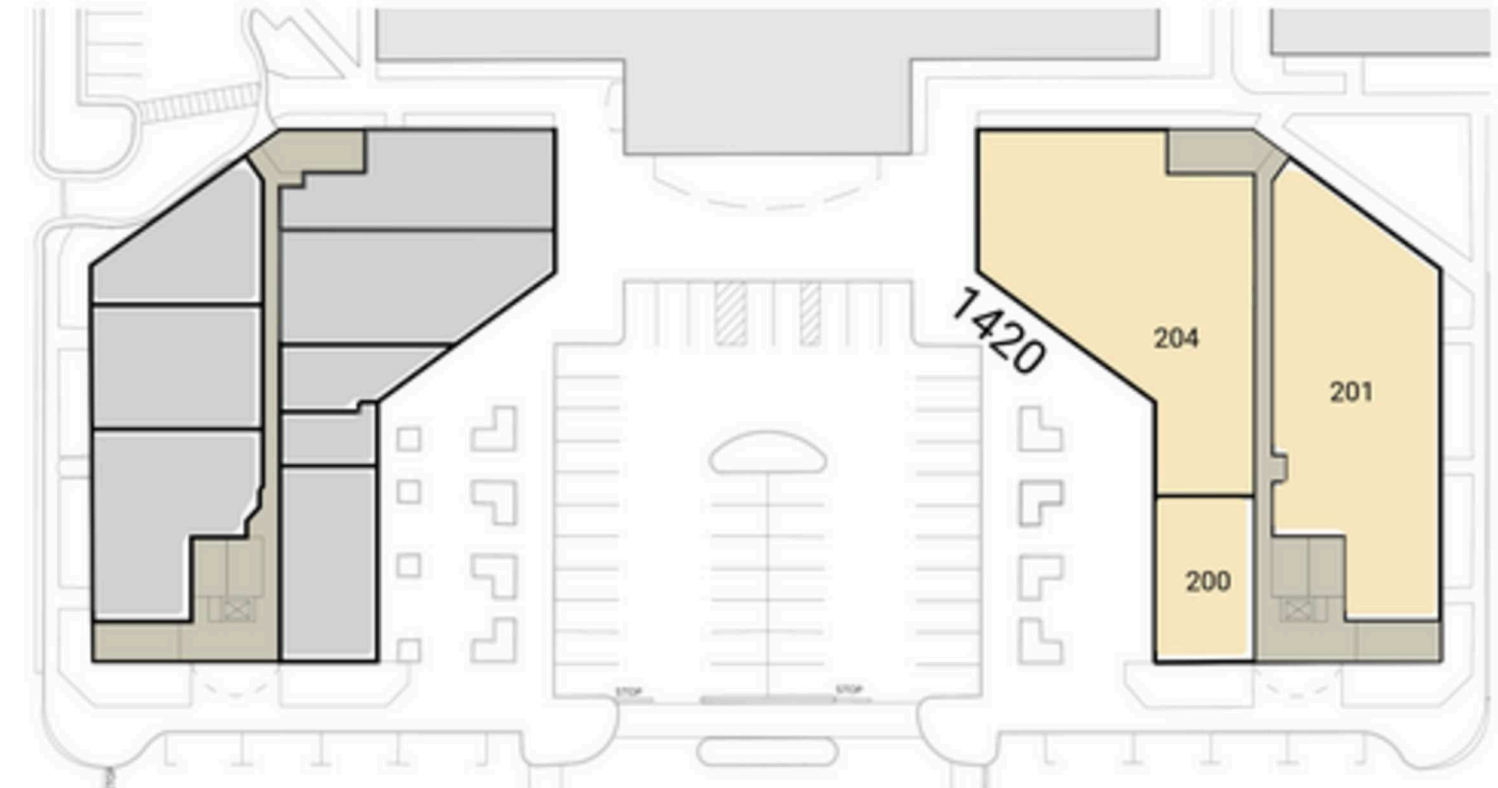
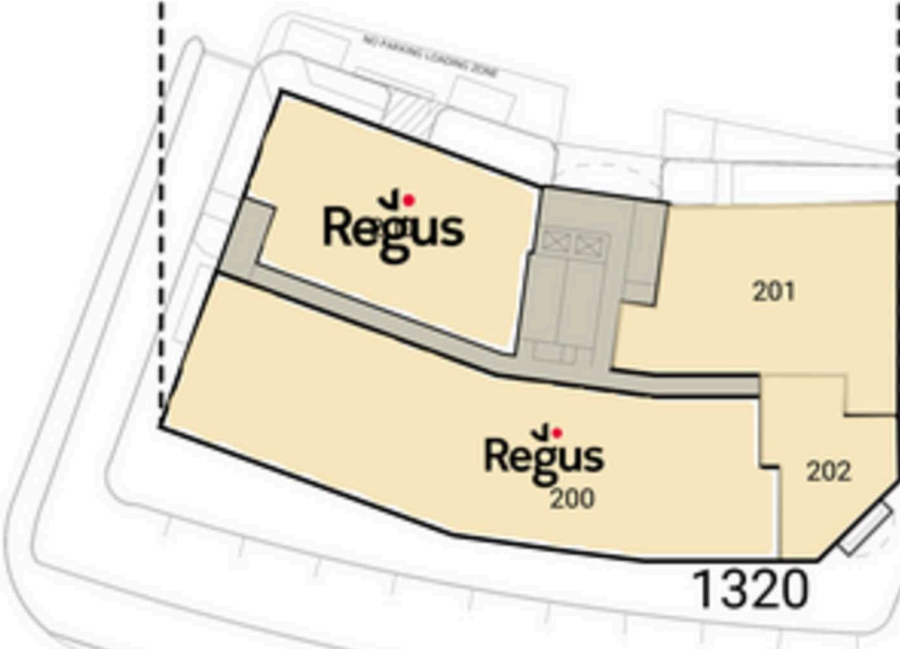

# Tenant List

Space #	Sq. Ft.	Tenant
1320-200	12,758	Regus
1320-201	3,978	C&F Mortgage
1320-202	1,635	TecX
1320-300	3,729	VA Department of Health
1320-302	4,060	Available
1320-304	4,764	Available
1320-307	1,611	The McCormick Group

Space #	Sq. Ft.	Tenant
1320-309	1,912	Bank of America
1320-310	2,192	Available
1320-400/ 406	5,359	IRS
1320-405	3,762	Available
1320-410	2,574	WRA
1320-412	2,210	Intuitive Counseling

Space #	Sq. Ft.	Tenant
1420-200	1,492	American Canoe Association
1420-201	5,083	VA Dental & Anesthesia Assoc.
1420-204	6,429	HomeServices Insurance
1440-201	3,500	PNC Bank
1440-203	9,446	GSA
1440-210	7,198	Samson Properties

**Discover your next retail opportunity at**  
**rappaportco.com**



**WASHINGTON, D.C. | MARYLAND | VIRGINIA**

**CENTRAL PARK CORPORATE CENTER | 1320 CENTRAL PARK BLVD, FREDERICKSBURG, VA**

**Susan Bourgeois | sbourgeois@rappaportco.com | 571.382.1288**