



Adaire
McLean, VA

1,442 SF available



McLean

Virginia

- Corner street front retail space in a 400-unit high-rise located in developing Tysons, with one of the largest retail concentrations in the region
- Highly accessible to Route 7 and Spring Hill Metro and great visibility from the Dulles Toll Road
- Located in the heart of Tysons’ transformation into a vibrant, high-density center projected to support 100,000 residents and 200,000 jobs by 2050



2025 Demographics

	1 mi.	3 mi.	5 mi.
Population	18,132	94,174	232,024
Daytime Population	39,061	119,072	186,335
Household Income	\$194,386	\$33,844	\$234,637
Traffic Counts	75,200 on Route 7/Leesburg Pike		

Area Retailers

Walmart

DUNKIN'

SHAKE SHACK

Starbucks

ULTA BEAUTY

CLUB PILATES



Tysons West Phase III

Tysons West

Adaire



Tysons 3

Tysons Galleria

The Boro

Pike 7 Plaza



Tysons Square

Tysons Corner Center

Site plan

1442 SF available

Space #	Sq. Ft.	Tenant
1	1442	Available
2	-	Club Pilates
3	-	Potbelly Sandwich Shop

● Space Available

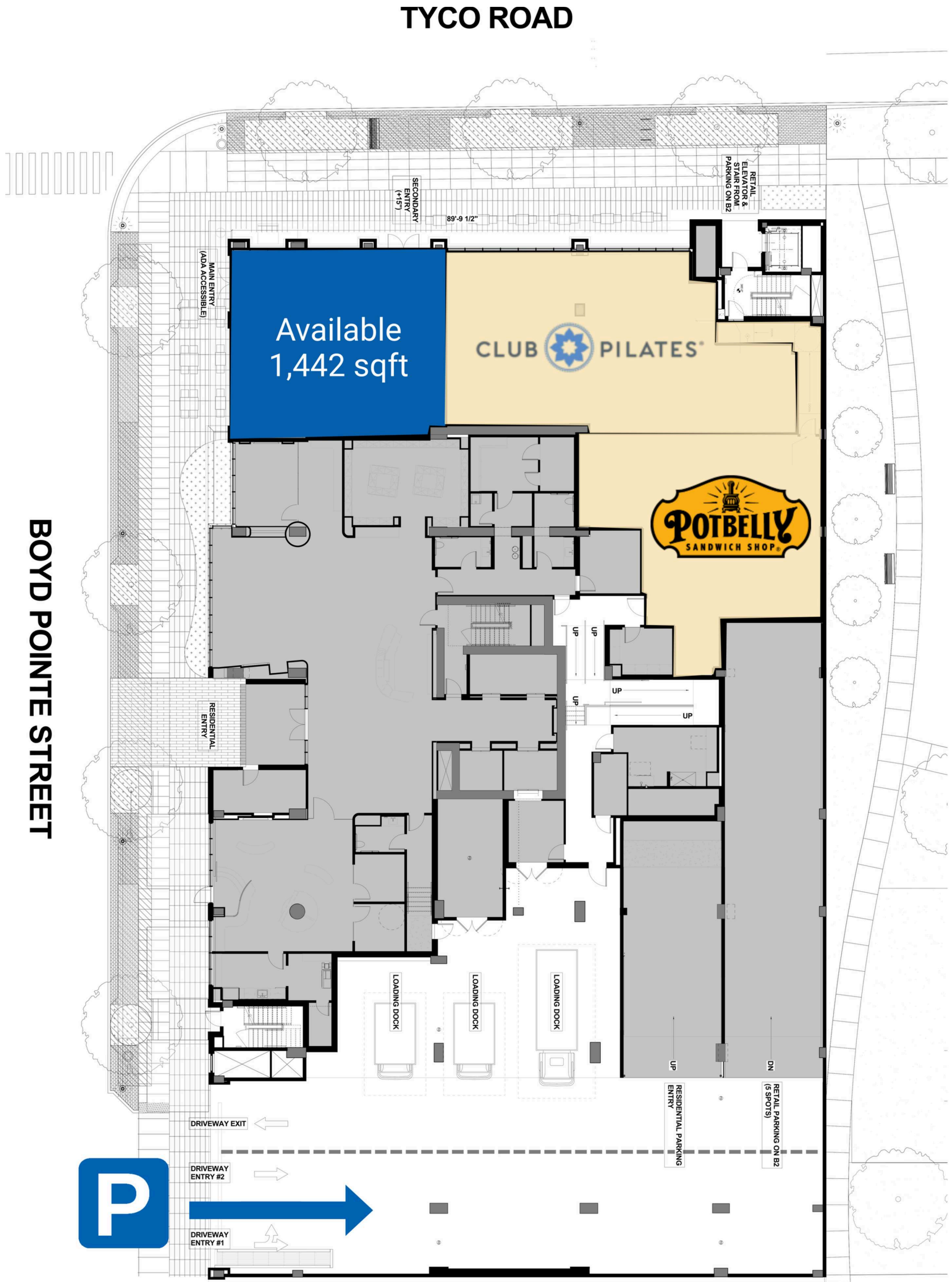

Discover your next retail opportunity at
rappaportco.com



WASHINGTON, D.C. | MARYLAND | VIRGINIA

ADAIRE | TYCO ROAD, MCLEAN, VA

Zach Elcano | zelcano@rappaportco.com | 571.382.1228